

2. BRANNVERNTEGNINGER

Det branntekniske tegningssettet skal gi et bilde av brannsikringen i bygningen/objektet, og det skal gjøre det lettere for brannvernlederen å følge opp at de brannforebyggende tiltakene fungerer som forutsatt.

Tegningssettet skal inneholde:

- Områdetegning/situasjonskart som viser bygningens/anleggets plassering i forhold til omgivelsene
- Oversikt over symbolikken som er benyttet i tegningssettet
- Brannvernplan for hver etasje
- Typiske vertikalsnitt med angivelse av etasjeutnyttelse
- Rednings- og beredskapsplaner for type a – objekter (se retningslinjene)

Brannvernplanene skal vise plasseringen av:

- Brannvegger, branncellebegrensende vegger og rominndeling
- Branndører med brannklasse
- Rømningsveier (husk at rømningsveier skal føres som egne brannceller til det fri)
- Interntrapper, forbindelser o.l.
- Håndsløkkeutstyr
- Tekniske installasjoner som brannalarmsentral, sprinklerventil og nøkkelskap
- Brannfarlige-, eksplosive-, giftige eller miljøfarlige stoffer

Hvis alarm- eller sprinkleranlegget bare dekker deler av et bygg/objekt, skal dekningsområdet markeres.

**TEGNINGSSETTET ER I FØRSTE REKKE EN
HJELP TIL SELVHJELP.
GJENNOMFØR INTERNKONTROLLEN!**

LINDEMANSALEN

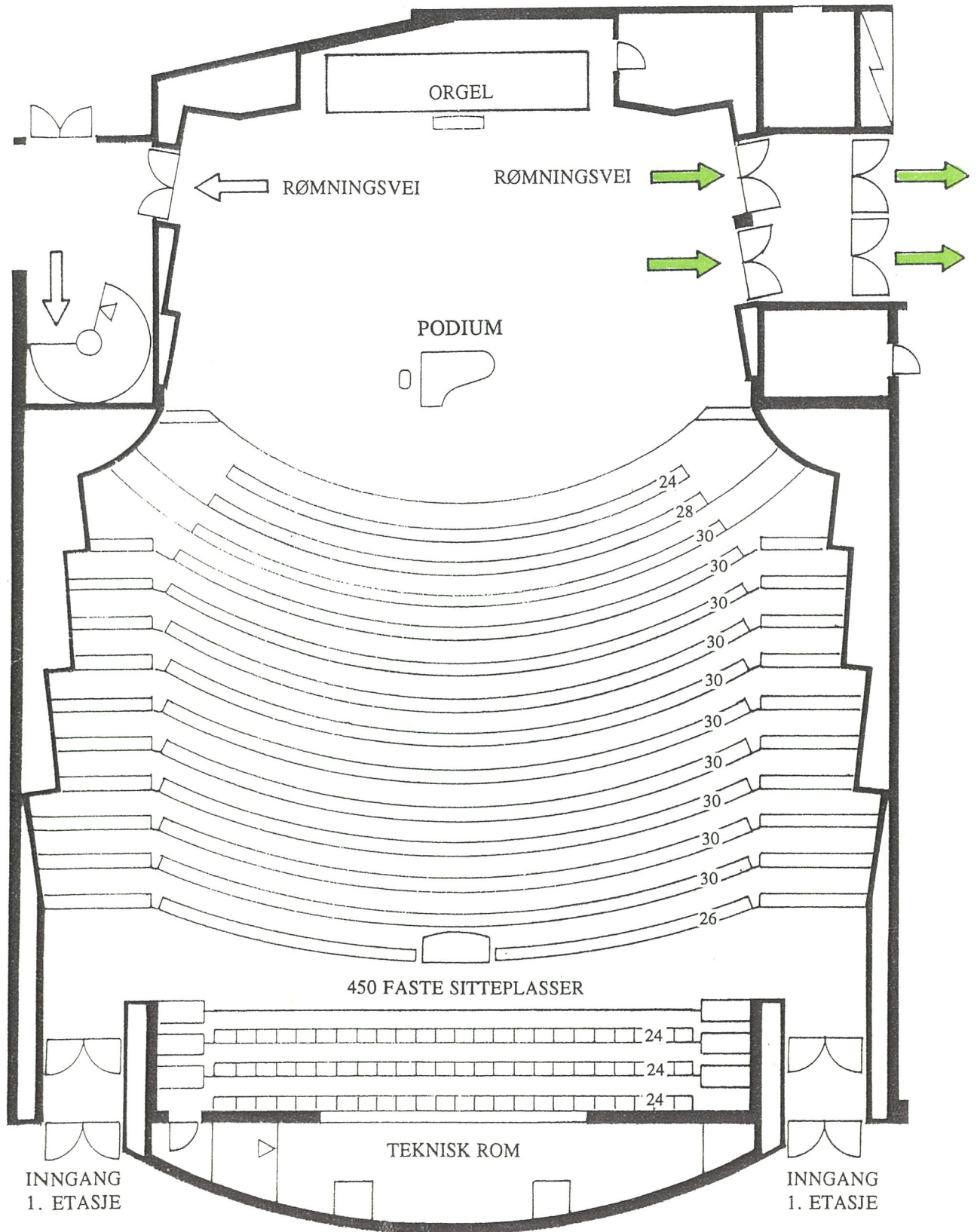

BRANNINSTRUKS

Med hensyn til brannloven § 22, 23, og 25 samt byggeforskriftene kap. 33 tillates :

Norges musikkhøgskole - Lindemandssalen

brukt som forsamlingslokale på følgende vilkår:

- | | | |
|--------------------------|---|--------------|
| <input type="checkbox"/> | Største antall personer som samtidig kan oppholde seg i lokalet | 700 personer |
| <input type="checkbox"/> | Største antall faste sitteplasser | 450 stk. |
| <input type="checkbox"/> | Antall stolrader | 16 stk |
| <input type="checkbox"/> | Største antall stoler i en rad | 30 stk |
| <input type="checkbox"/> | Avstand mellom stolradene | 95 cm |
| <input type="checkbox"/> | Minimum bredde sideganger | 180 cm |
| <input type="checkbox"/> | Alle nødutganger er merket med grønt lys | - OK |
| <input type="checkbox"/> | Alle utgangsdører slår ut i gangretningen og må under ingen omstendighet sperres eller blokkeres når lokalen er i bruk. | - OK |
| <input type="checkbox"/> | Reservelys bassert på batterikilde | - OK |

Ved brann ring telefon 110 eller 22 11 44 55

KAMMERSALEN

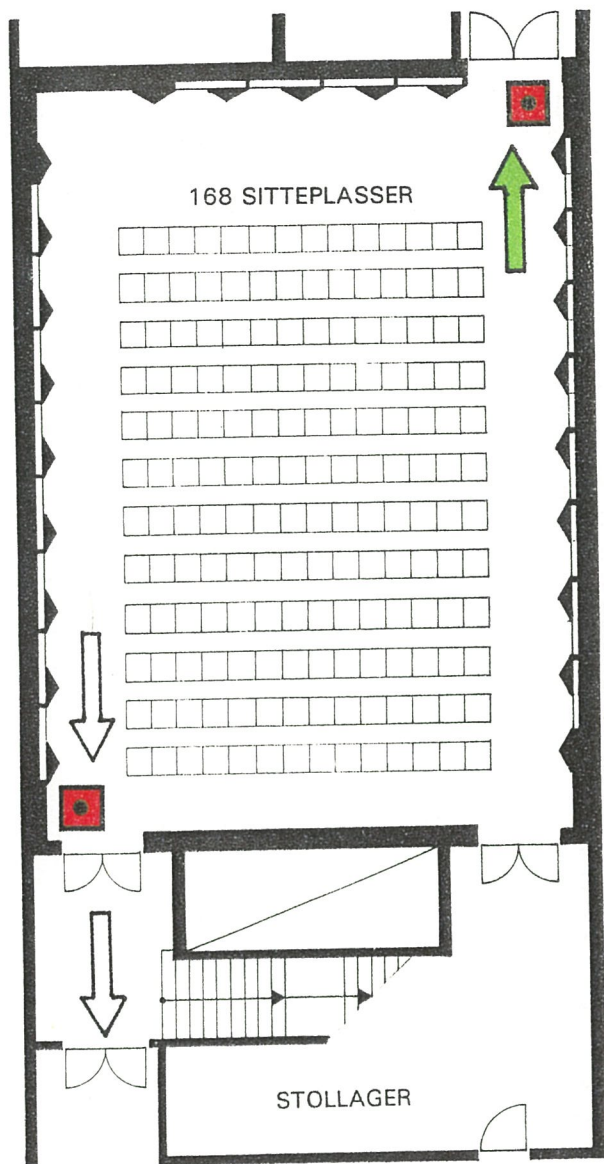

GULV UNDERETASJE

-  Manuell brannmelder
-  Hovedrømningsvei

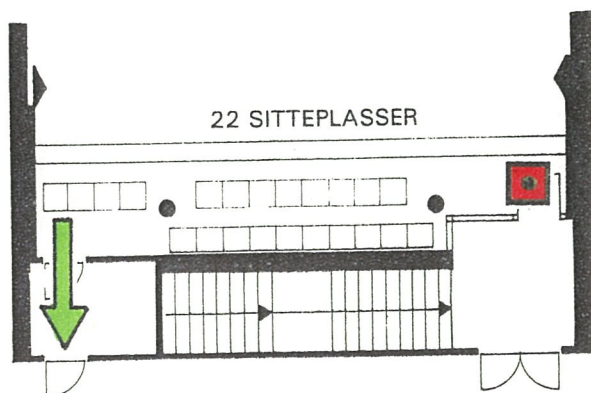

GALLERI 1. ETASJE

BRANNINSTRUKS

Med hensyn til brannloven § 22, 23, og 25 samt byggeforskriftene kap. 33 tillates :

Norges musikkhøgskole - Kammmersalen

brukt som forsamlingslokale på følgende vilkår:

- | | | |
|--------------------------|---|--------------|
| <input type="checkbox"/> | Største antall personer som samtidig kan oppholde seg i lokalet | 300 personer |
|--------------------------|---|--------------|







På gulv i underetasje :

- | | | |
|--------------------------|--------------------------------|----------|
| <input type="checkbox"/> | Største antall sitteplasser | 168 stk. |
| <input type="checkbox"/> | Antall stolrader | 12 stk |
| <input type="checkbox"/> | Største antall stoler i en rad | 14 stk |
| <input type="checkbox"/> | Avstand mellom stolradene | 100 cm |
| <input type="checkbox"/> | Minimum bredde sideganger | 140 cm |





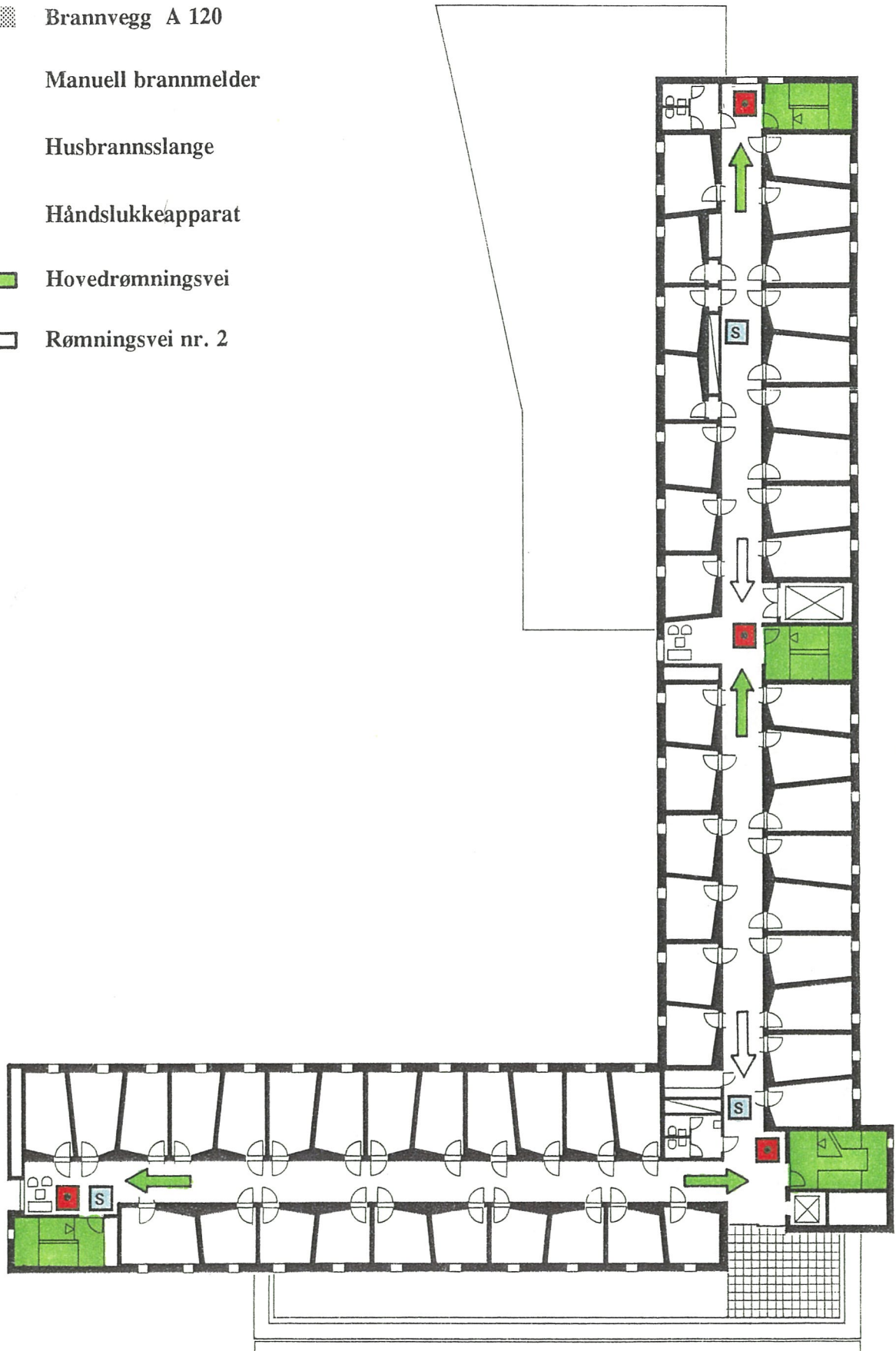

På galleri i 1. etasje:

- | | | |
|--------------------------|---|--------|
| <input type="checkbox"/> | Største antall sitteplasser | 22 stk |
| <input type="checkbox"/> | Antall stolrader | 2 stk |
| <input type="checkbox"/> | Antall stoler i en rad | 11 stk |
| <input type="checkbox"/> | Alle nødutganger er merket med grønt lys | - OK |
| <input type="checkbox"/> | Alle utgangsdører slår ut i gangretningen og må under ingen omstendighet sperres eller blokkeres når lokalen er i bruk. | - OK |
| <input type="checkbox"/> | Reserverlys bassert på batterikilde | - OK |





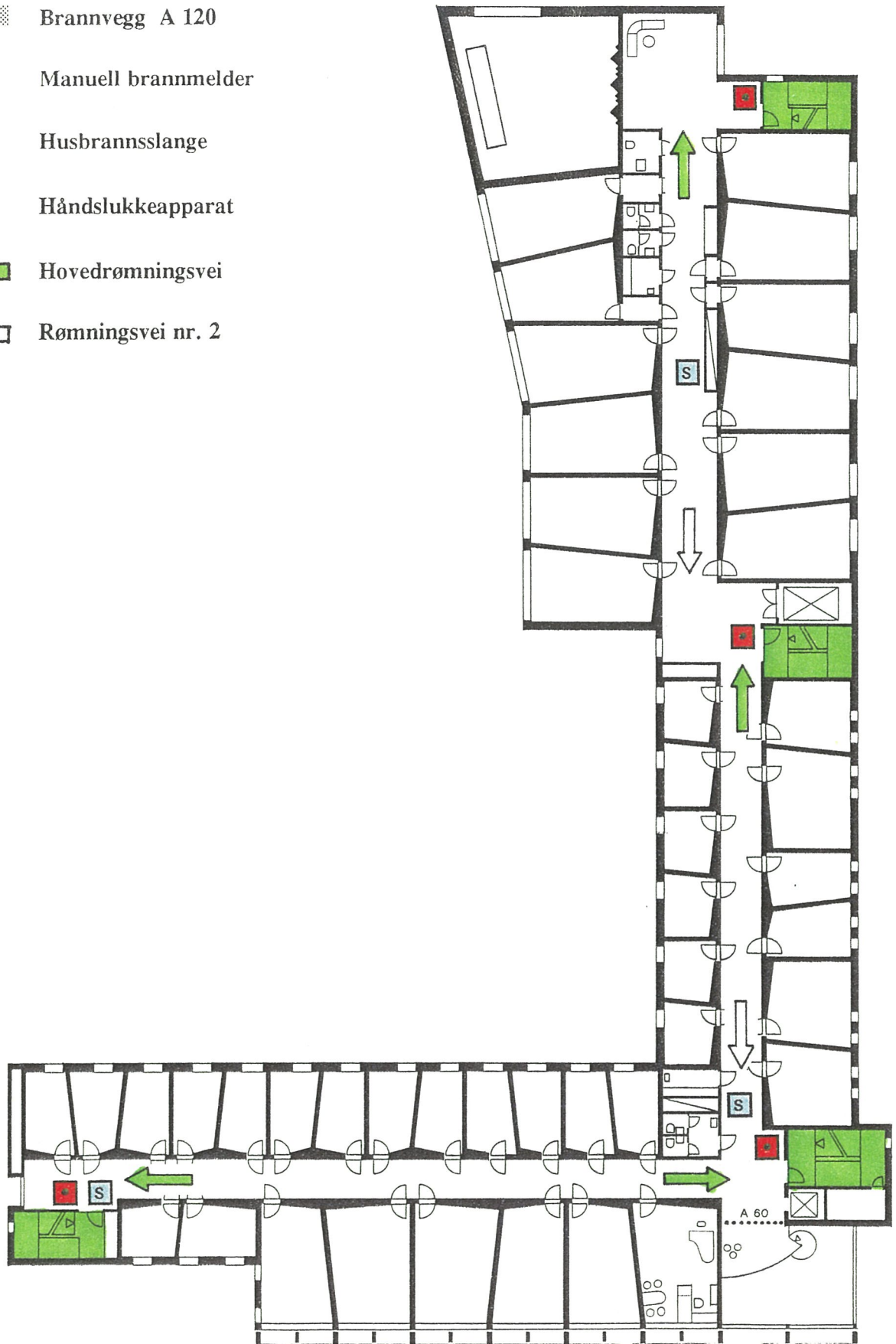

Ved brann ring telefon **110** eller **22 11 44 55**

-  Brannvegg A 120
-  Manuell brannmelder
-  Husbrannsslange
-  Håndslukkeapparat
-  Hovedrømningsvei
-  Rømningsvei nr. 2







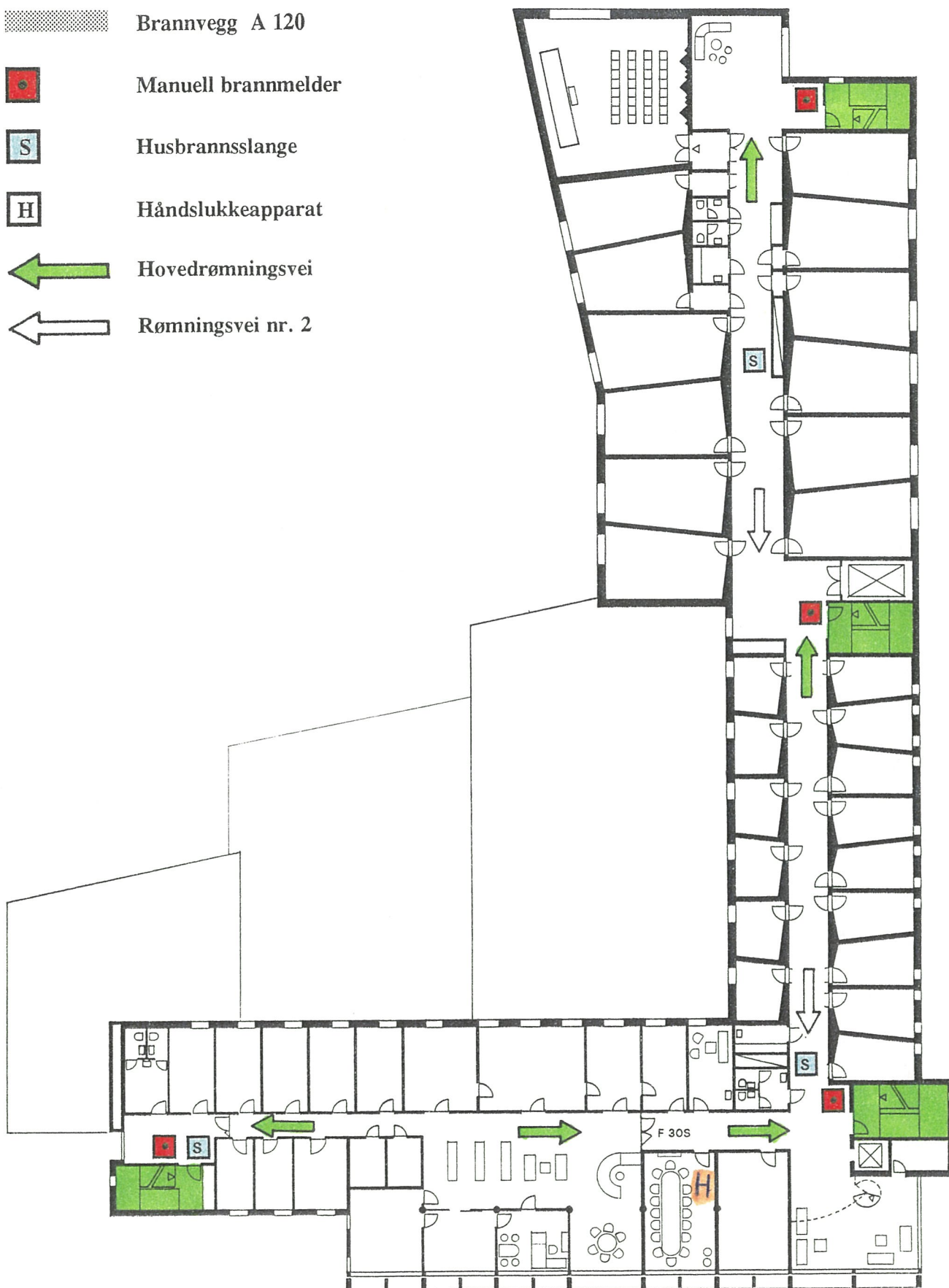

-  Brannvegg A 120
-  Manuell brannmelder
-  Husbrannsslange
-  Håndslukkeapparat
-  Hovedrømningsvei
-  Rømningsvei nr. 2











-  Brannvegg A 120
-  Manuell brannmelder
-  Husbrannsslange
-  Håndslukkeapparat
-  Hovedrømningsvei
-  Rømningsvei nr. 2





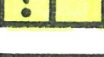

-  Brannvegg A 120
-  Manuell brannmelder
-  Husbrannsslange
-  Håndslukkeapparat
-  Hovedrømningsvei
-  Rømningsvei nr. 2

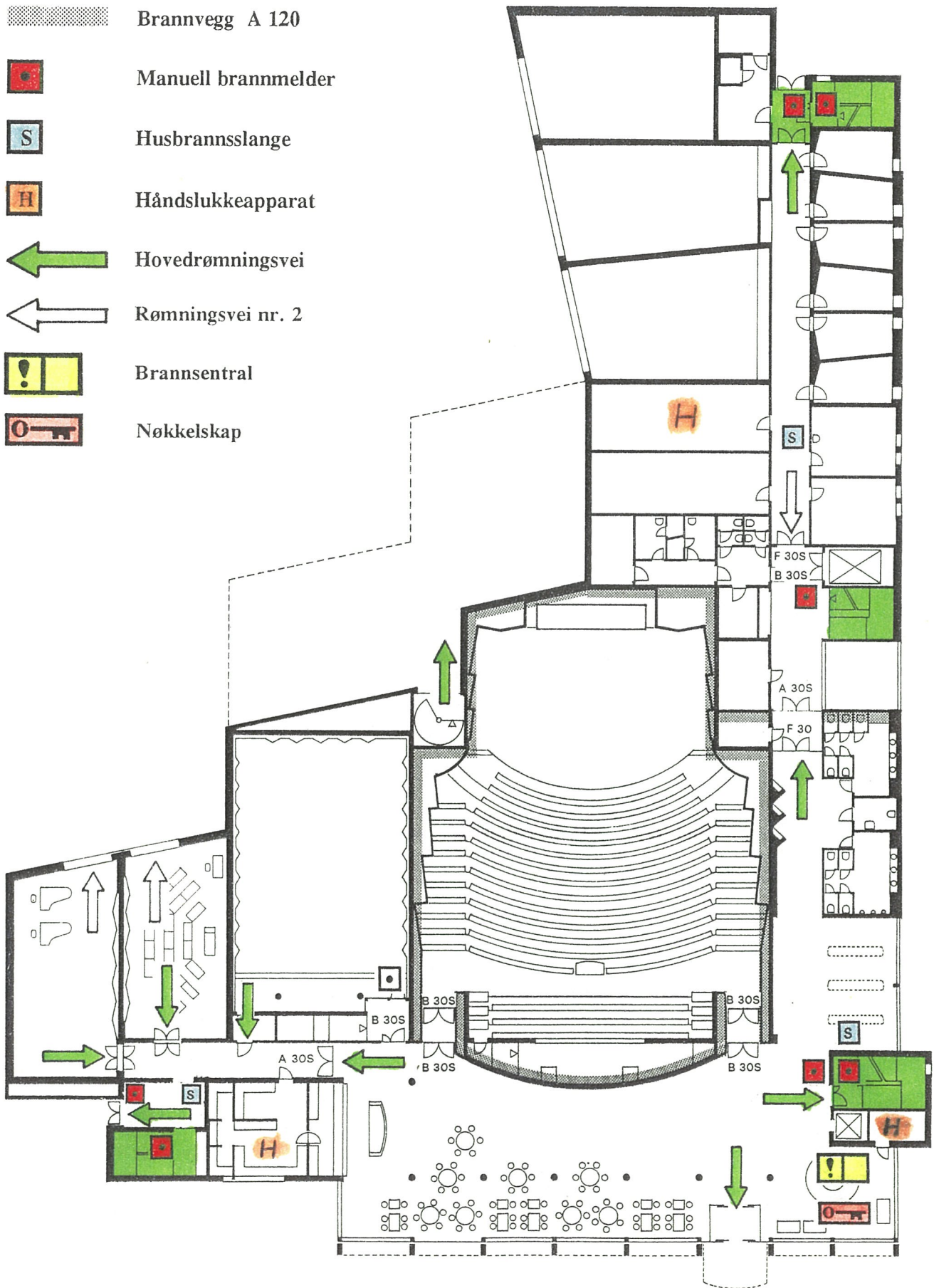





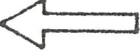

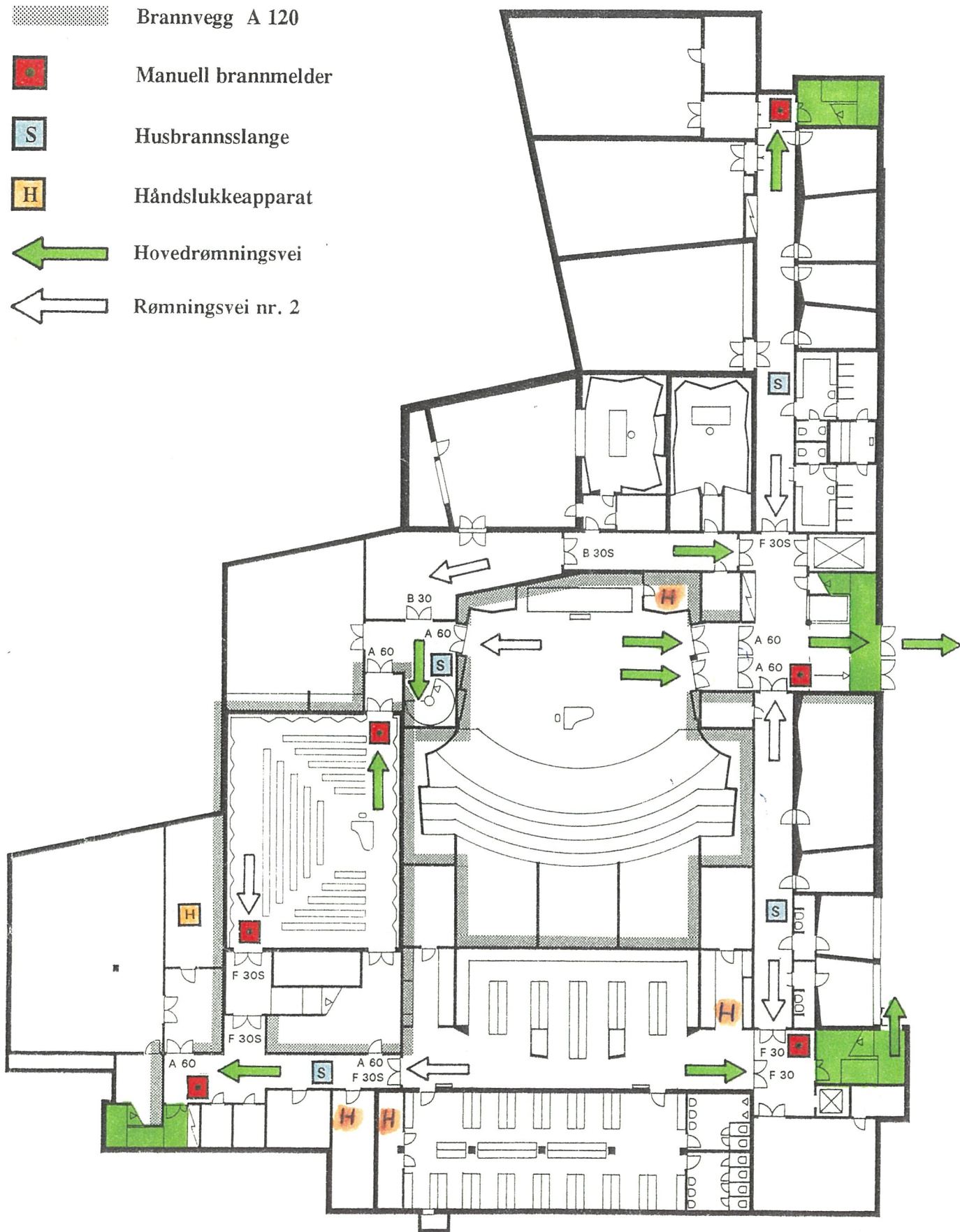
-  Brannvegg A 120
-  Manuell brannmelder
-  Husbrannsslange
-  Håndslukkeapparat
-  Hovedrømningsvei
-  Rømningsvei nr. 2
-  Brannsentral
-  Nøkkelskap



-  Brannvegg A 120
-  Manuell brannmelder
-  Husbrannsslange
-  Håndslukkeapparat
-  Hovedrømningsvei
-  Rømningsvei nr. 2



-  Brannvegg A 120
-  Manuell brannmelder
-  Husbrannsslange
-  Håndslukkeapparat
-  Hovedrømningsvei
-  Rømningsvei nr. 2

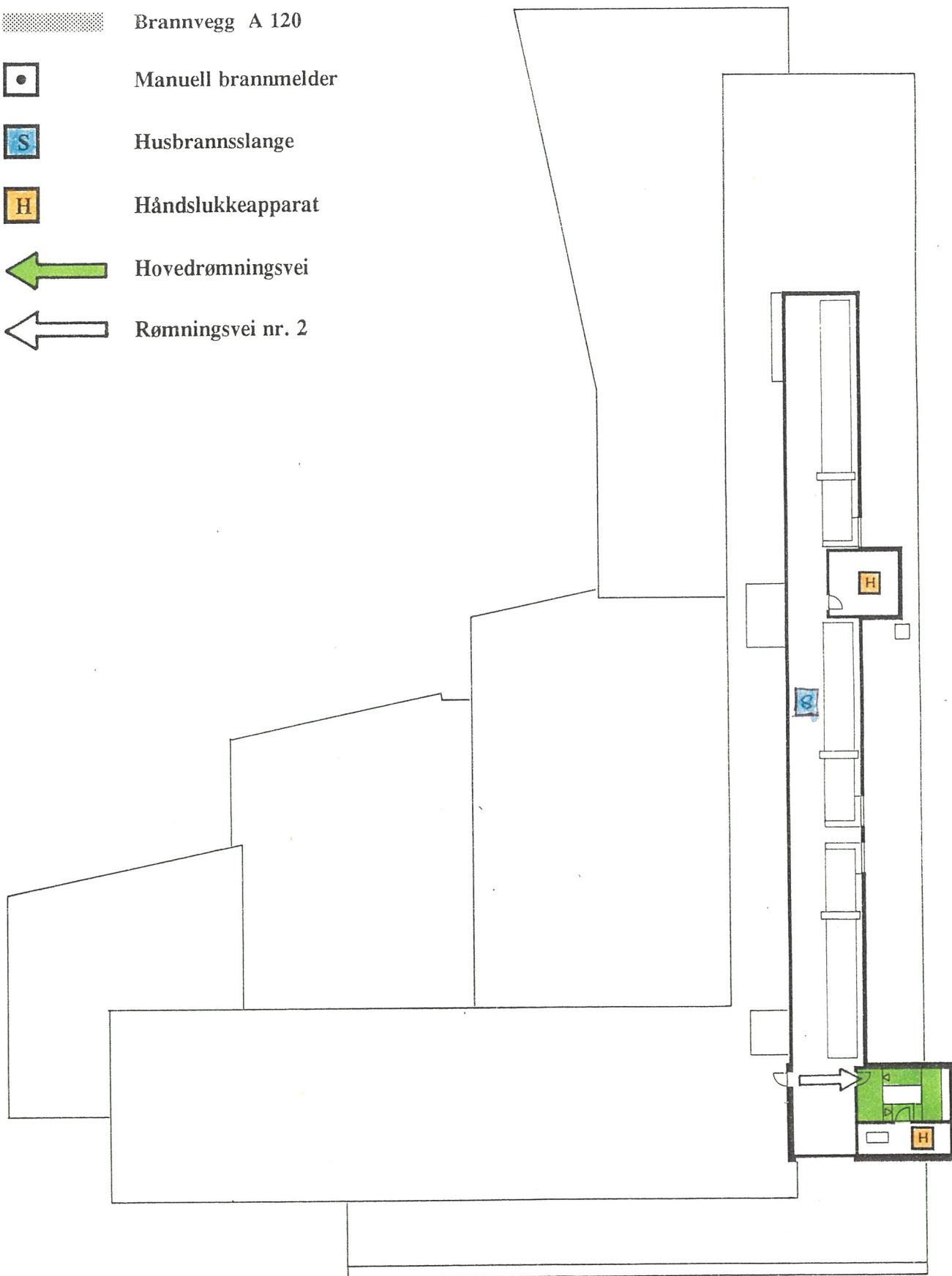

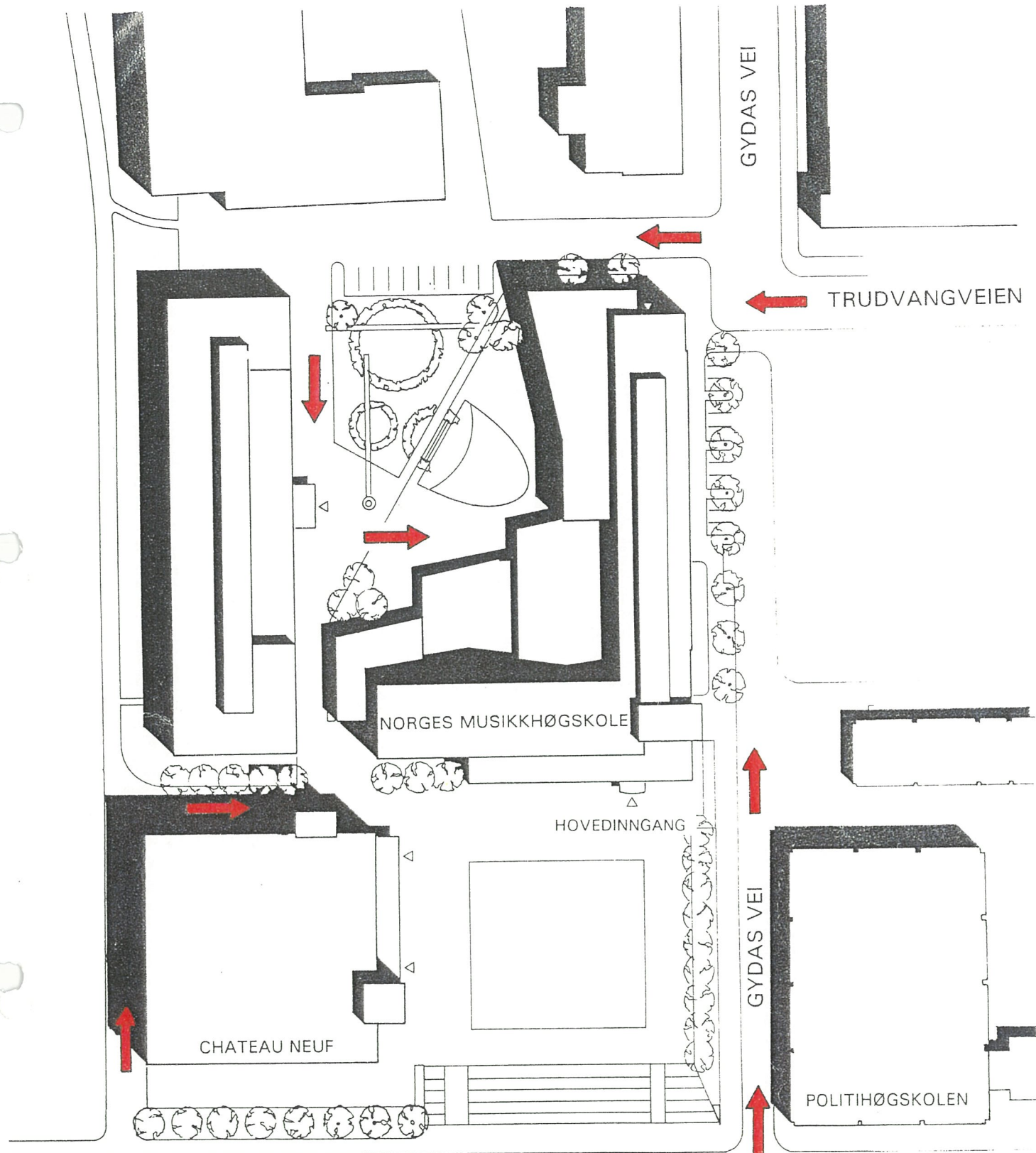

 KJØREADKOMST FOR BRANNBILER