

Wi-Fi Network Report

DWG-EXPORT-Plan00

Survey routes and Access Points for DWG-EXPORT-Plan00

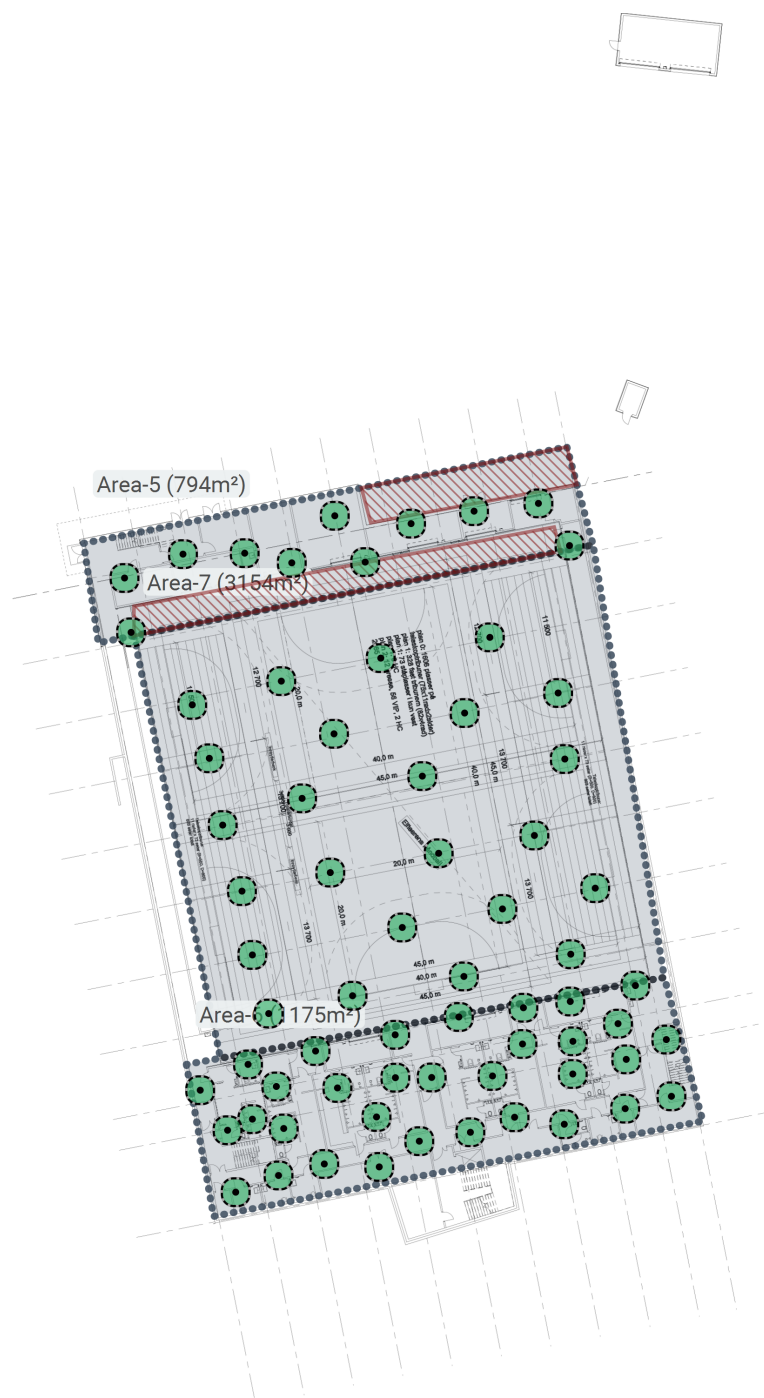

View as / Project Offset:	Mobile Device
---------------------------	---------------

Area-5 (486 m²)

Coverage Requirement: Cisco Design Guideline		
2.4 GHz	Signal Strength Min	-65.0 dBm
	Secondary Signal Strength Min	-75.0 dBm
	Signal-to-Noise Ratio Min	25.0 dB
	Data Rate Min	12 Mbps
	Channel Interference Max	1 at min. -86.0 dBm
	Round Trip Time (RTT) Max	300 ms
	Packet Loss Max	2.0 %
5 GHz	Signal Strength Min	-65.0 dBm
	Secondary Signal Strength Min	-75.0 dBm
	Signal-to-Noise Ratio Min	25.0 dB
	Data Rate Min	12 Mbps
	Channel Interference Max	1 at min. -86.0 dBm
	Round Trip Time (RTT) Max	300 ms
	Packet Loss Max	2.0 %

DWG-EXPORT-Plan01

Survey routes and Access Points for DWG-EXPORT-Plan01

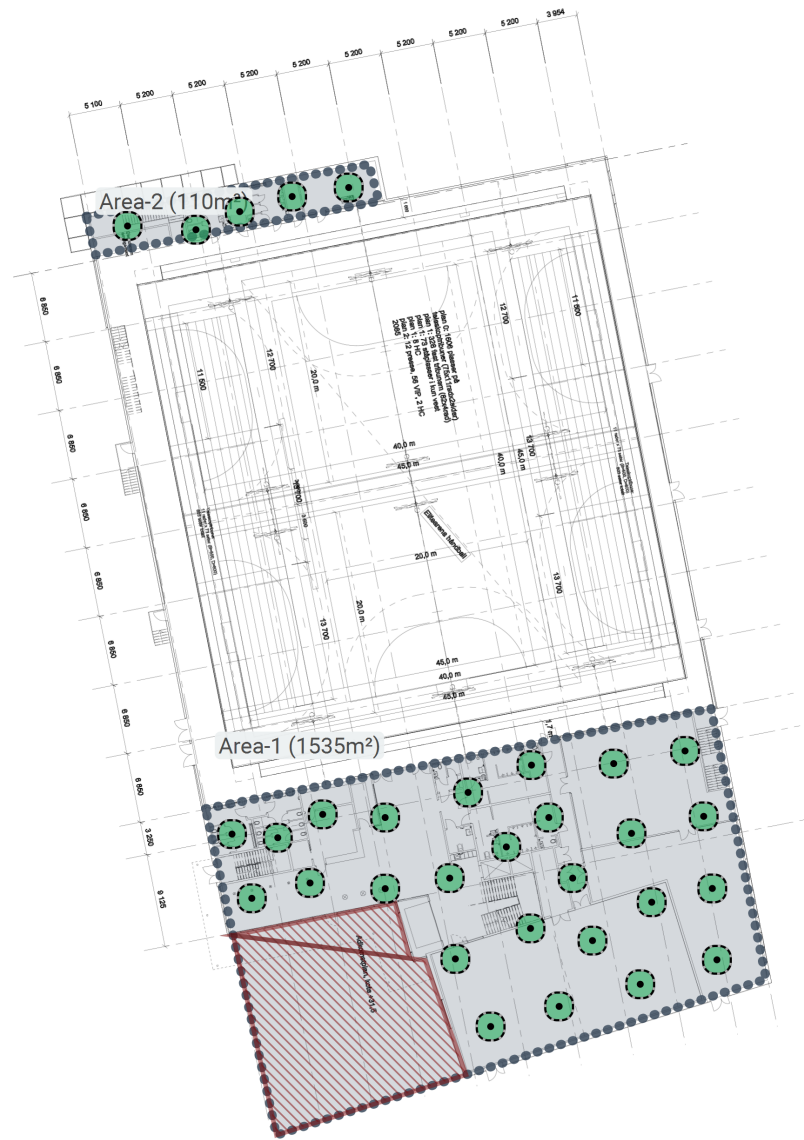

View as / Project Offset:	Mobile Device
---------------------------	---------------

Area-1 (1,188 m²)

Coverage Requirement: Cisco Design Guideline		
2.4 GHz	Signal Strength Min	-65.0 dBm
	Secondary Signal Strength Min	-75.0 dBm
	Signal-to-Noise Ratio Min	25.0 dB
	Data Rate Min	12 Mbps
	Channel Interference Max	1 at min. -86.0 dBm
	Round Trip Time (RTT) Max	300 ms
	Packet Loss Max	2.0 %
5 GHz	Signal Strength Min	-65.0 dBm
	Secondary Signal Strength Min	-75.0 dBm
	Signal-to-Noise Ratio Min	25.0 dB
	Data Rate Min	12 Mbps
	Channel Interference Max	1 at min. -86.0 dBm
	Round Trip Time (RTT) Max	300 ms
	Packet Loss Max	2.0 %

DWG-EXPORT-Plan02

Survey routes and Access Points for DWG-EXPORT-Plan02

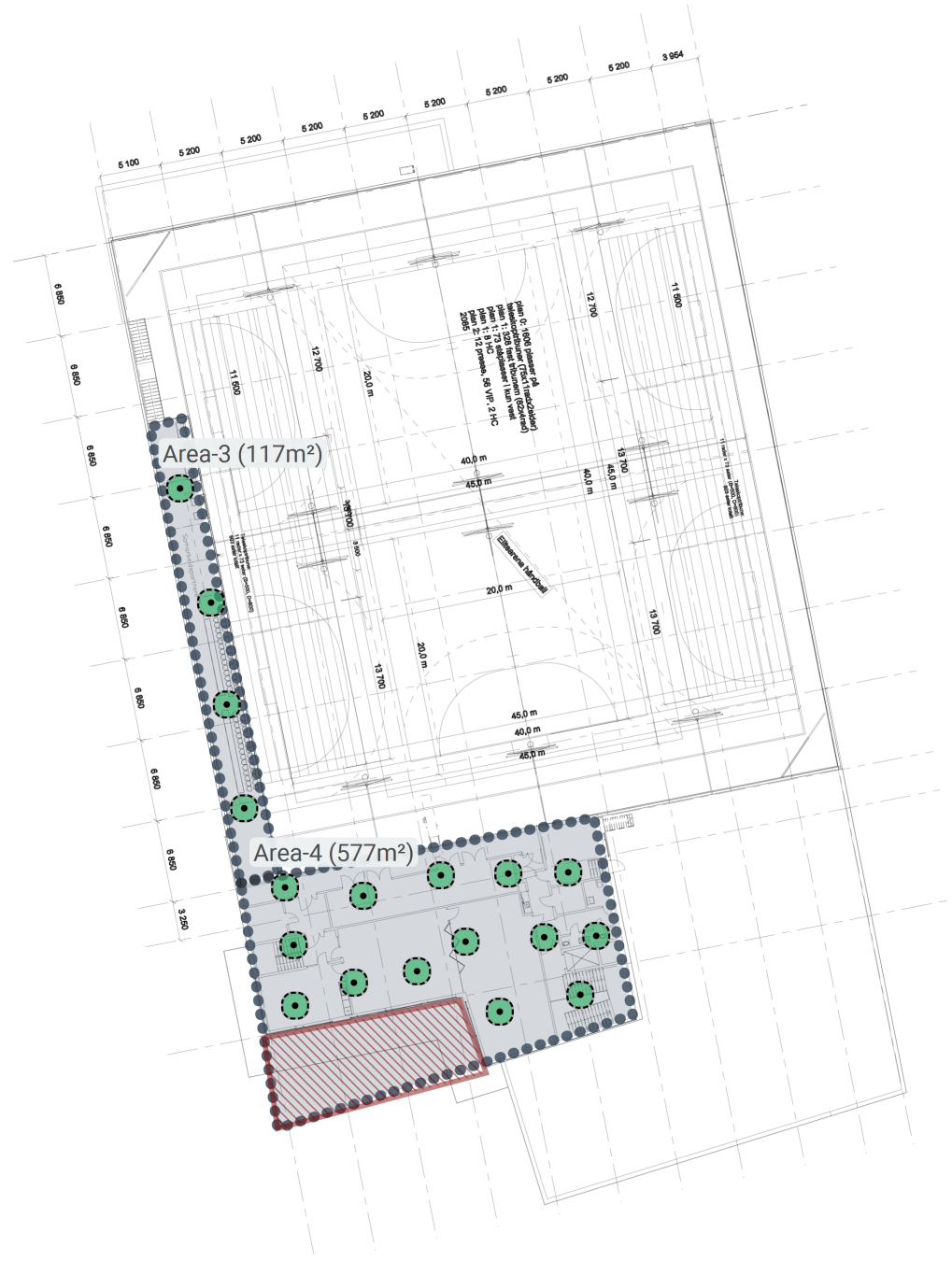

View as / Project Offset:	Mobile Device
---------------------------	---------------

Area-3 (117 m²)

Coverage Requirement: Cisco Design Guideline		
2.4 GHz	Signal Strength Min	-65.0 dBm
	Secondary Signal Strength Min	-75.0 dBm
	Signal-to-Noise Ratio Min	25.0 dB
	Data Rate Min	12 Mbps
	Channel Interference Max	1 at min. -86.0 dBm
	Round Trip Time (RTT) Max	300 ms
	Packet Loss Max	2.0 %
5 GHz	Signal Strength Min	-65.0 dBm
	Secondary Signal Strength Min	-75.0 dBm
	Signal-to-Noise Ratio Min	25.0 dB
	Data Rate Min	12 Mbps
	Channel Interference Max	1 at min. -86.0 dBm
	Round Trip Time (RTT) Max	300 ms
	Packet Loss Max	2.0 %