

GRUNDRISS SETT FRA UNDERSIDEN

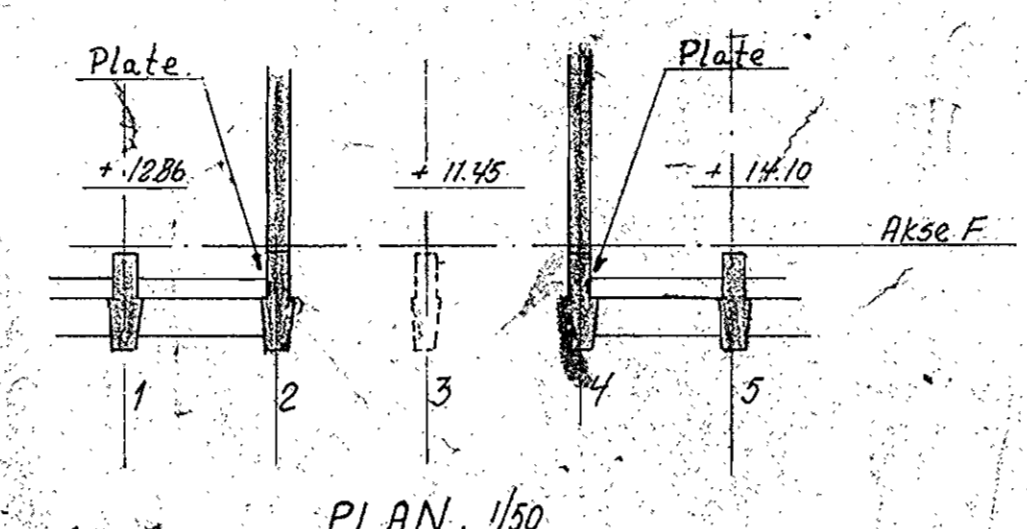

PLAN 150

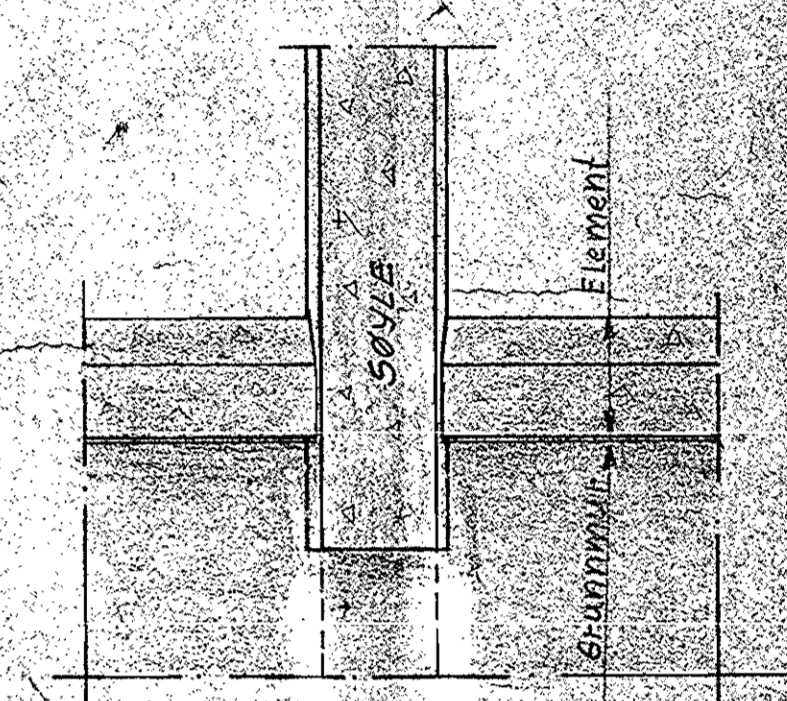

DETAIL B 1/10

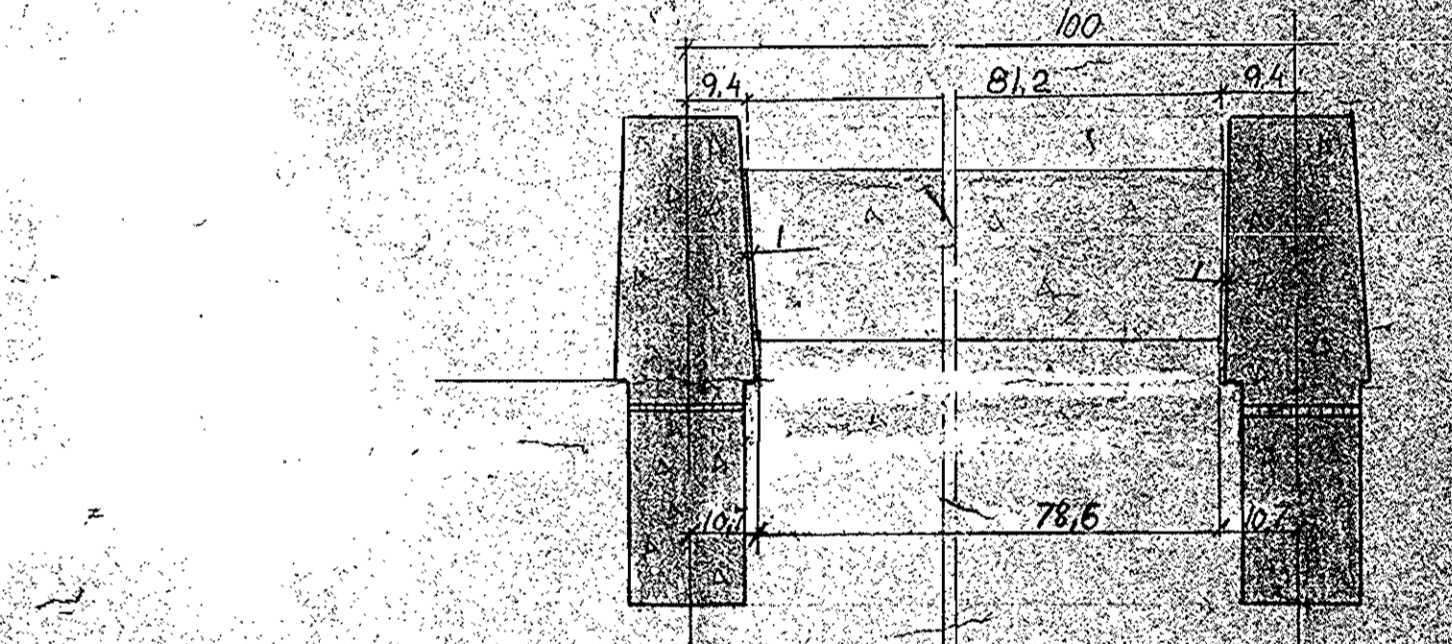
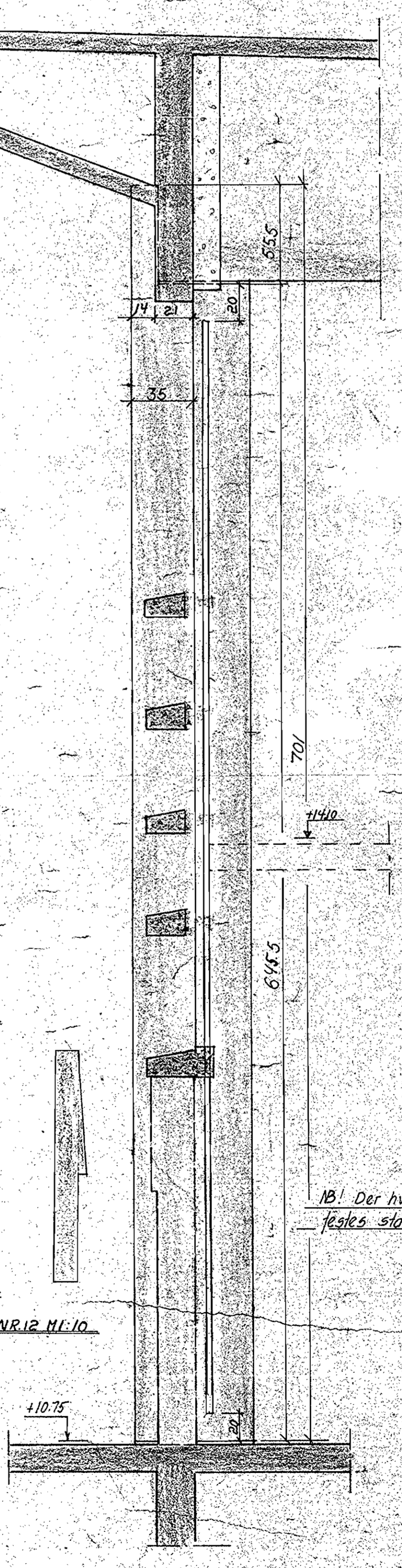
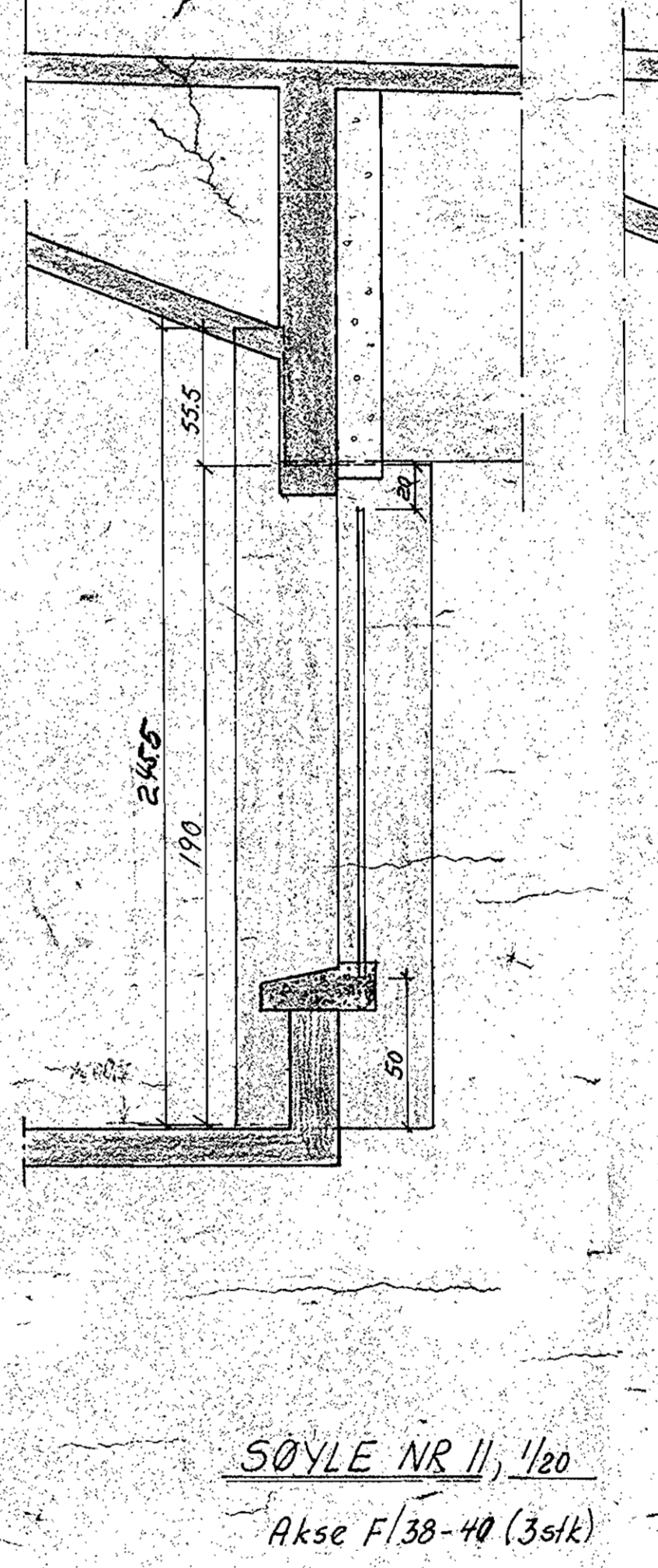
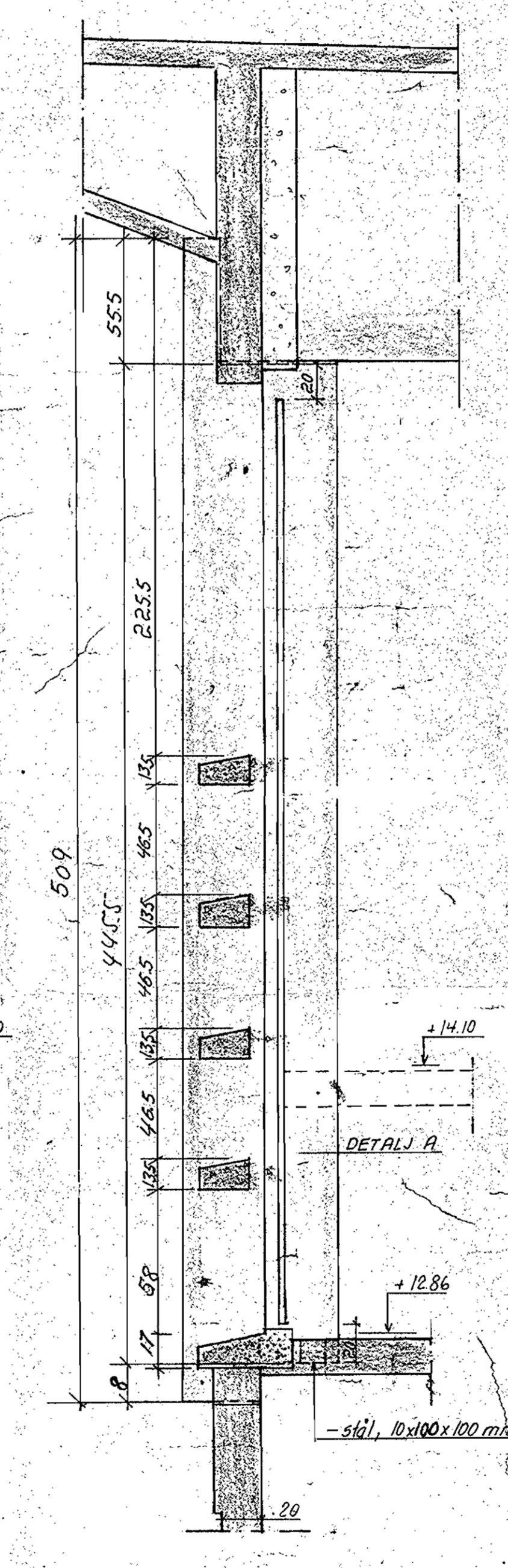
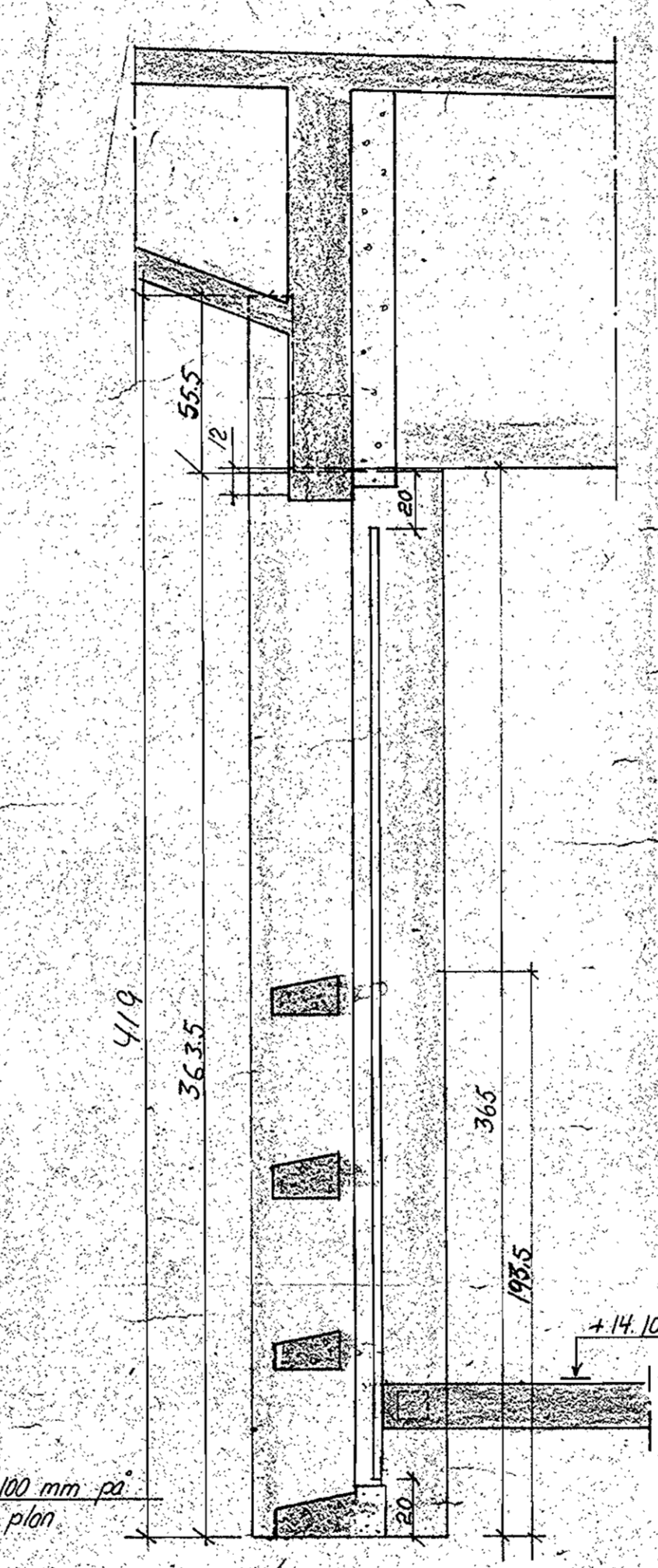
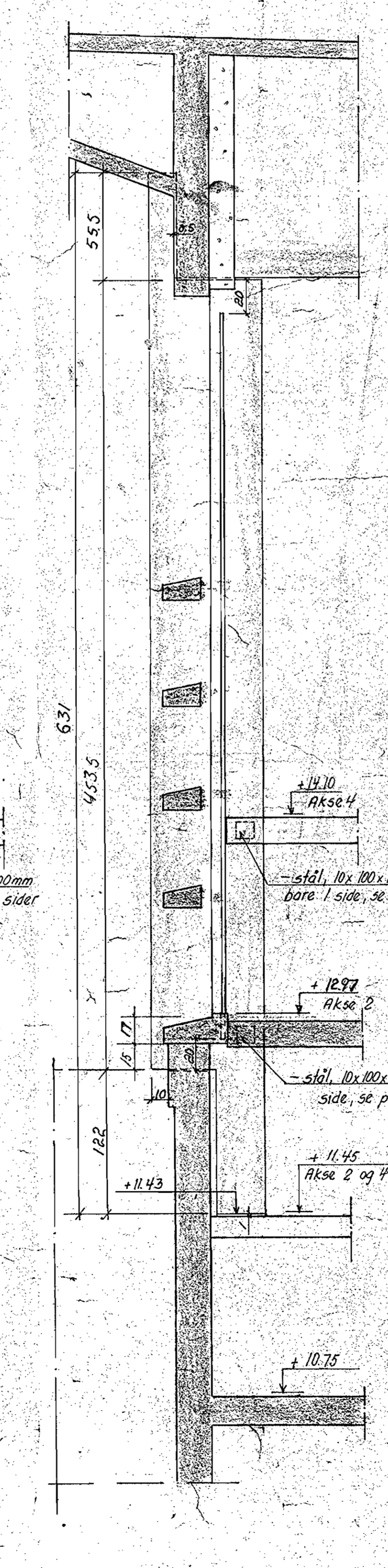
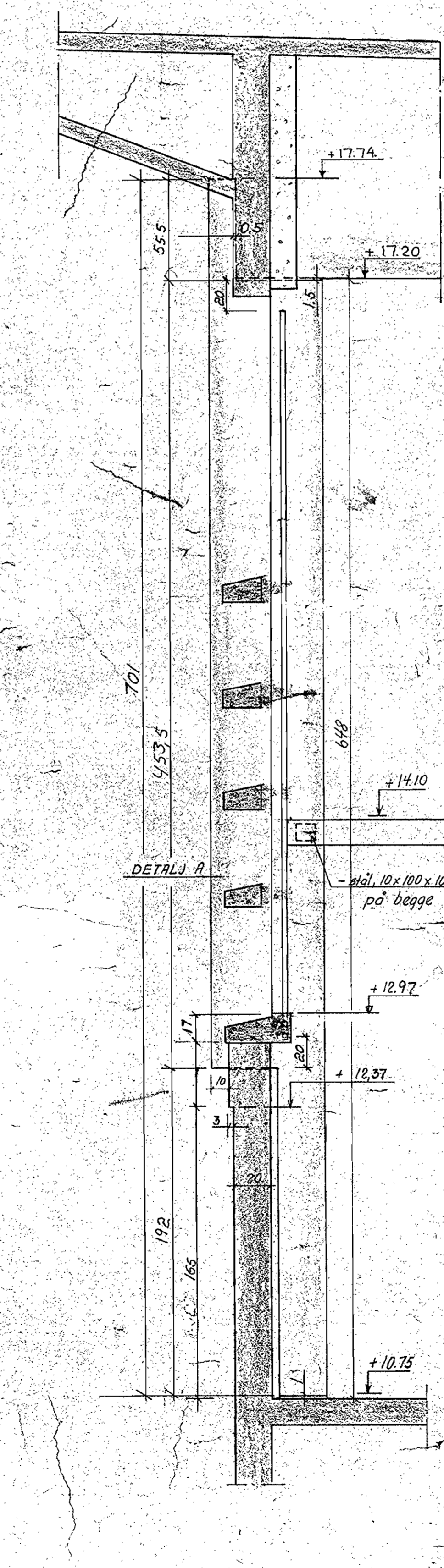
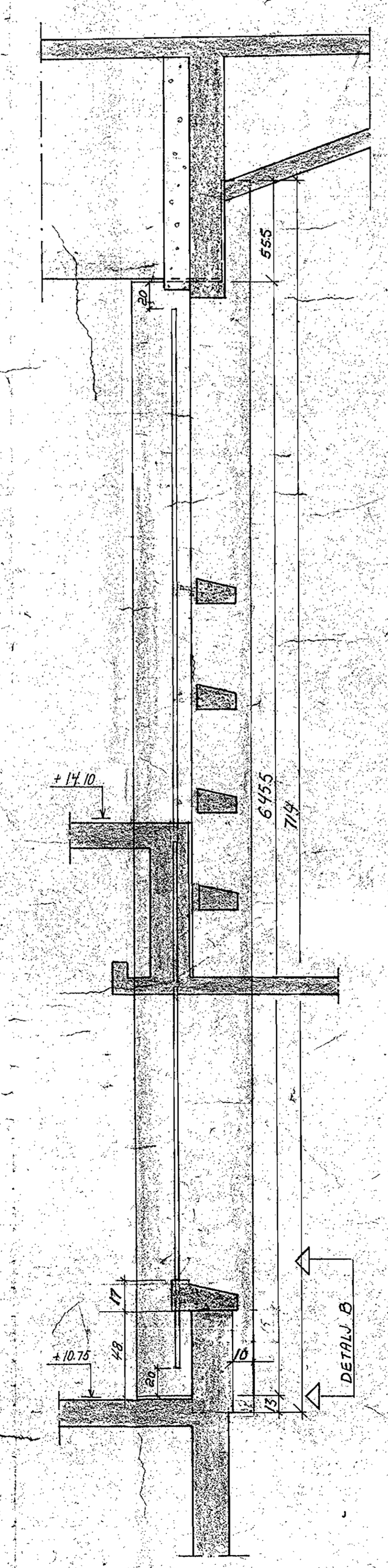
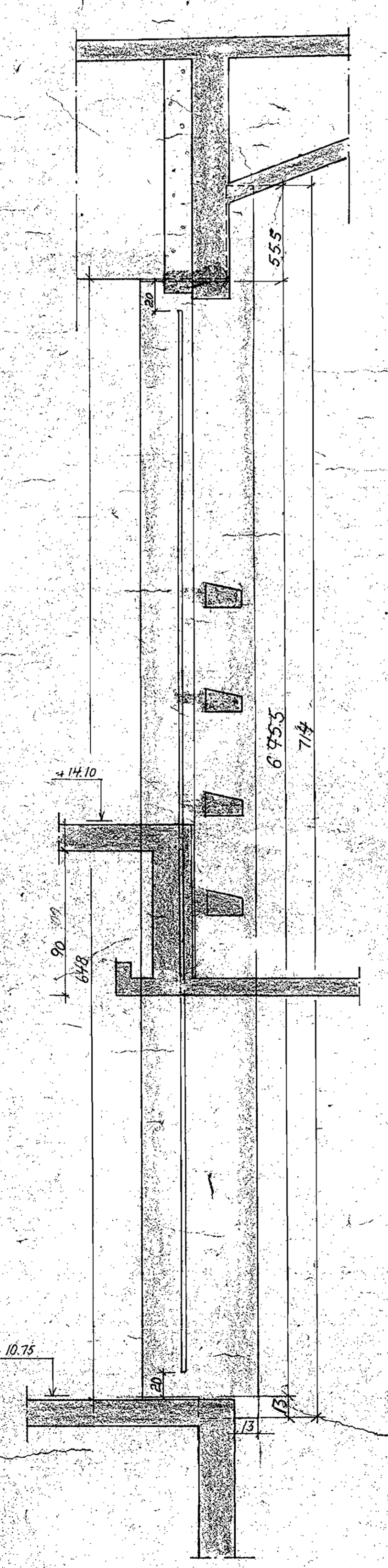
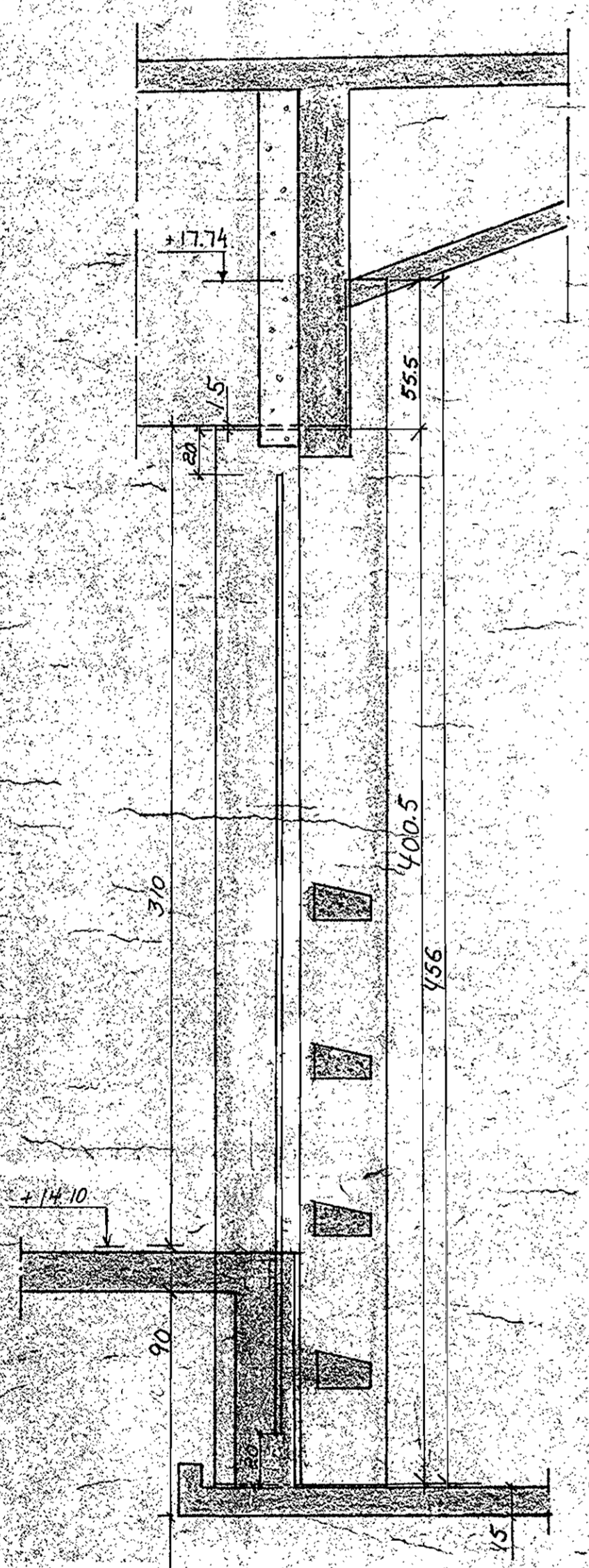
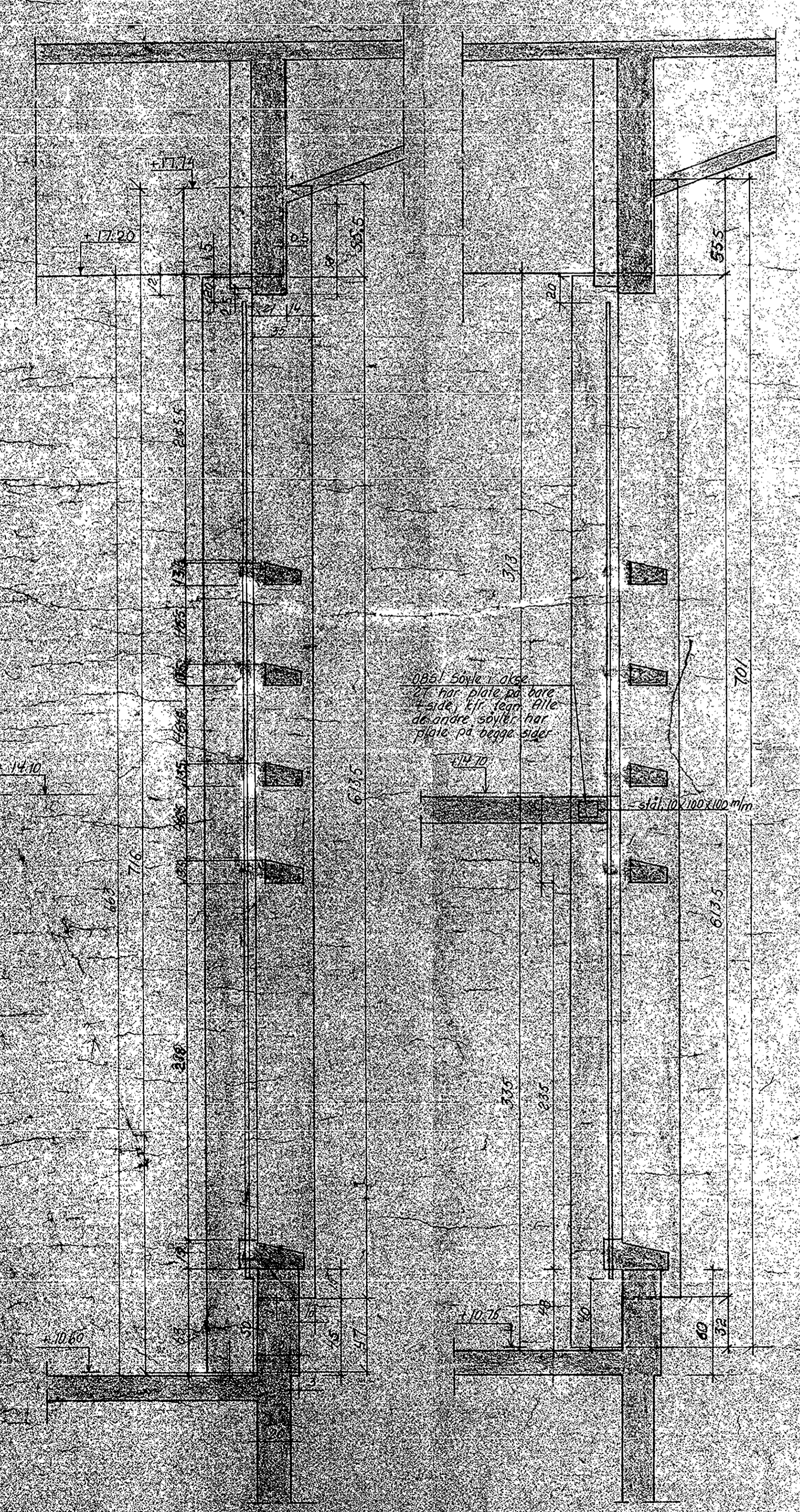

HORIZONTALT BÅND MELLOM SØYLER 1/5

Mellom de horisontale bånd og søyler skal det elastically fuge masser på alle steder.

10! Der hvor ikke noe annet beskrives, plates ståplater på begge sider av søyler.

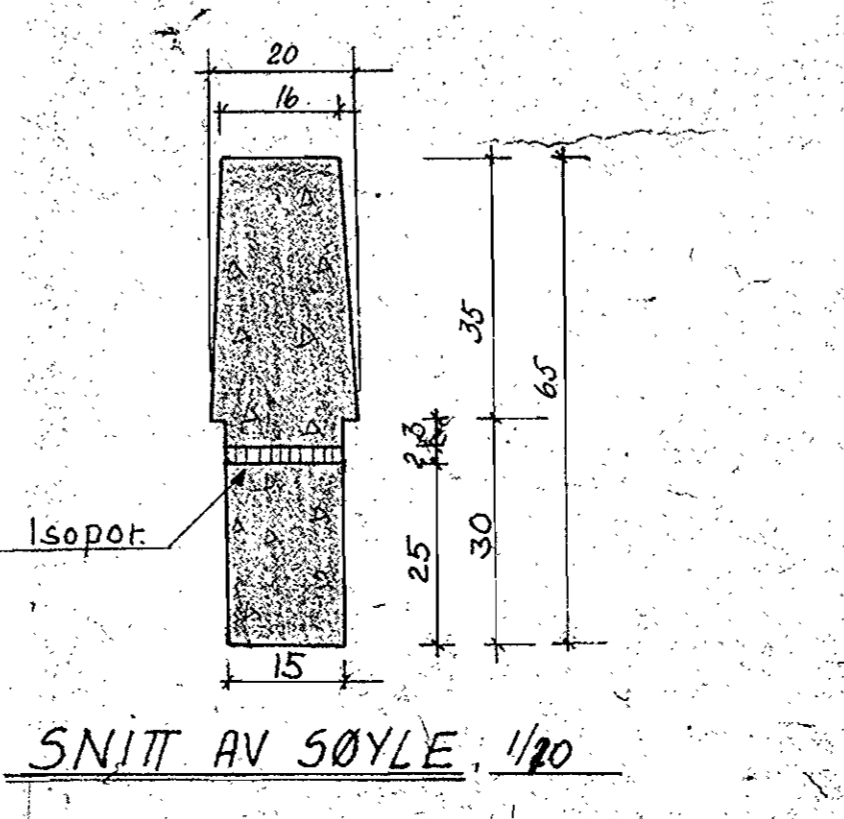

OPDRAGSVEIER	TEGNINGEN
SKOLE SAMFUNNS	ELEMENTER
HUS 11	FLANG
BRUNNØYSSUND	FASADER
INGENIØRONTORGET	REVISJON
INGENIØRONTORGET	REVISJON