

Sæterlia

Rapport fra lysberegning i Sæterlia iht. Tr.kommunes Veglysnorm for lysklasse CE5.

Kontaktperson: YR
Ordrenr.: 20.009
Firma: Prosjektutvikling Midt-Norge AS
Kundenr.: -

Dato: 16.01.2020
Designer: YR



Prosjektutvikling Midt-Norge AS

Vestre Rosten 85
7075 TillerDesigner YR
Telefon
Faks
E-Post yngve@pumn.no

Innholdsfortegnelse

Sæterlia

Tittelside	1
Innholdsfortegnelse	2
PHILIPS BPP530 T25 1 xLED40/740 DK DF	
Armaturdata	3
PHILIPS BPP530 T25 1 xLED35/740 DW	
Armaturdata	4
PHILIPS BGP352 T25 1xGRN49-3S/740 DW	
Armaturdata	5
Utendørsriss	
Armaturstykkliste	6
Gatevurderingsfelter (koordinatliste)	7
Rendering av falske farger	8
Utvendige overflater	
Gatevurderingsfelt 1	
Gråskala (E)	9
Boliggate	
Planleggingsdata	10
Lystekniske resultater	11
Adkomstvei	
Planleggingsdata	12
Armaturstykkliste	13
Lystekniske resultater	14



Prosjektutvikling Midt-Norge AS

Vestre Rosten 85
7075 TillerDesigner YR
Telefon
Faks
E-Post yngve@pumn.no**PHILIPS BPP530 T25 1 xLED40/740 DK DF / Armaturdata**

Lysutstråling 1:

Armaturklassifasjon etter CIE: 100
CIE Flux Code: 41 76 96 100 71

CitySoul LED gen2 - a versatile identity CitySoul gen2 LED is one of the most versatile and inspirational urban street lighting families designed by Philips to date. This highly efficient range delivers excellent lighting levels whilst also providing the right ambiance for all urban application areas, from the outskirts of the city right through to the city center. By evolving the modularity of the CitySoul family and adding new innovations like the Lyre and the Accent bracket, Philips has made this range the ideal toolbox for every urban context. The design is flatter, completely round, and the transitions with the spigot and bracket entirely flush, thereby giving your cityscape a coherent, elegant and discreet identity. Designed around its LED engine, CitySoul gen2 LED is highly efficient and easy to maintain. It comes in two sizes and is suitable for side-entry, post-top, catenary and suspended mounting. Thanks to the built in Philips Ledgine optimized LED platform, and the wide range of available application-tailored optics, CitySoul LED gen2 delivers the right amount light and in the right direction on your street, enabling further energy savings. The luminaire comes with one or two Philips SR (System Ready) sockets, which makes the luminaire future ready. What this means is that CitySoul LED gen2 is ready to be paired with both standalone and advanced control and lighting software applications such as Interact City from Signify. Next to this, each individual luminaire is uniquely identifiable, thanks to the Philips Service tag application. With a simple scan of a QR code, placed on the inside of the mast door or directly on the luminaire, you gain instant access to the luminaire configuration, making maintenance and programming operations faster and easier, and enabling you to create your digital library of lighting assets and spare parts. CitySoul LED gen2 can also be equipped with our dedicated light recipe that preserves a dark night sky.

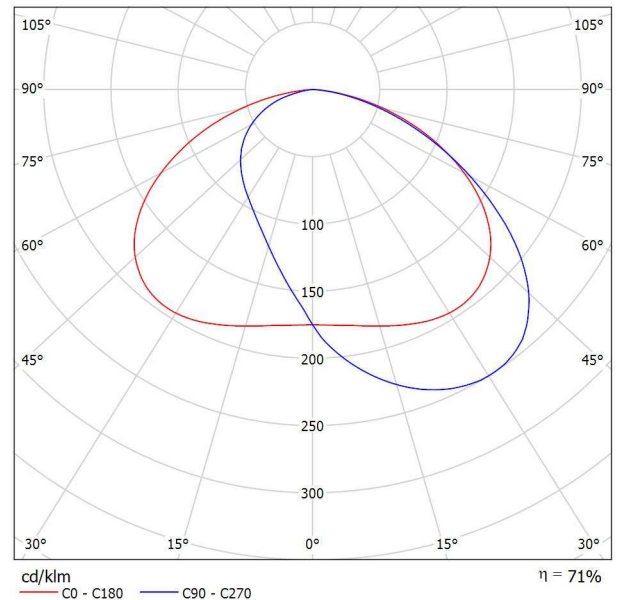

På grunn av manglende symmetriegenskaper kan det ikke vises noen UGR-tabell for denne lampen.



Prosjektutvikling Midt-Norge AS

Vestre Rosten 85
7075 TillerDesigner YR
Telefon
Faks
E-Post yngve@pumn.no**PHILIPS BPP530 T25 1 xLED35/740 DW / Armaturdata**

Lysutstråling 1:

Armaturklassifisering etter CIE: 100
CIE Flux Code: 38 72 97 100 86

CitySoul LED gen2 - a versatile identity CitySoul gen2 LED is one of the most versatile and inspirational urban street lighting families designed by Philips to date. This highly efficient range delivers excellent lighting levels whilst also providing the right ambiance for all urban application areas, from the outskirts of the city right through to the city center. By evolving the modularity of the CitySoul family and adding new innovations like the Lyre and the Accent bracket, Philips has made this range the ideal toolbox for every urban context. The design is flatter, completely round, and the transitions with the spigot and bracket entirely flush, thereby giving your cityscape a coherent, elegant and discreet identity. Designed around its LED engine, CitySoul gen2 LED is highly efficient and easy to maintain. It comes in two sizes and is suitable for side-entry, post-top, catenary and suspended mounting. Thanks to the built in Philips Ledgine optimized LED platform, and the wide range of available application-tailored optics, CitySoul LED gen2 delivers the right amount light and in the right direction on your street, enabling further energy savings. The luminaire comes with one or two Philips SR (System Ready) sockets, which makes the luminaire future ready. What this means is that CitySoul LED gen2 is ready to be paired with both standalone and advanced control and lighting software applications such as Interact City from Signify. Next to this, each individual luminaire is uniquely identifiable, thanks to the Philips Service tag application. With a simple scan of a QR code, placed on the inside of the mast door or directly on the luminaire, you gain instant access to the luminaire configuration, making maintenance and programming operations faster and easier, and enabling you to create your digital library of lighting assets and spare parts. CitySoul LED gen2 can also be equipped with our dedicated light recipe that preserves a dark night sky.

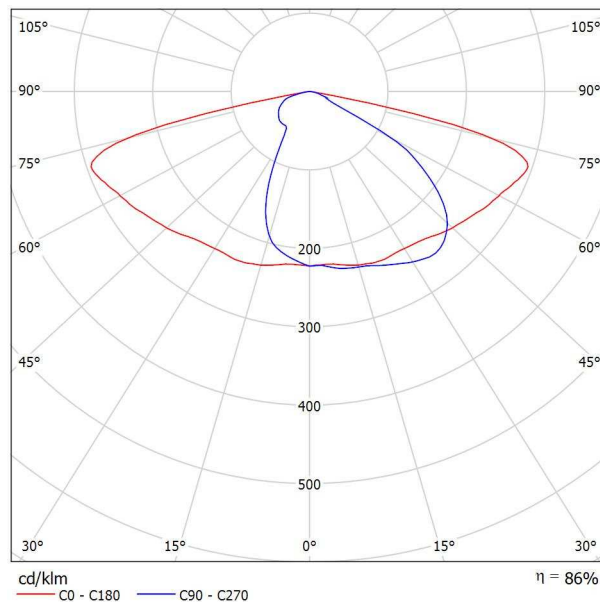

På grunn av manglende symmetriegenskaper kan det ikke vises noen UGR-tabell for denne lampen.



Prosjektutvikling Midt-Norge AS

Vestre Rosten 85
7075 Tiller

Designer YR
Telefon
Faks
E-Post yngve@pumn.no

PHILIPS BGP352 T25 1xGRN49-3S/740 DW / Armaturdata

Lysutstråling 1:



Armaturklassifasjon etter CIE: 100
CIE Flux Code: 39 75 97 100 91

Iridium² LEDGINE – lighting the road ahead Iridium² is a family of road-lighting luminaires designed for performance and sustainability. Depending on the application and budget, customers can start with LED, electronic HID or a mix of both technologies with the same luminaire. Whatever the initial choice, Iridium²'s modularity allows customers to upgrade their installations (LED to LED or e-HID to LED) whenever they want, simply by changing the light engine.

The integration of LEDGINE, brand new HID optics, electronic gear and controls is a response to the growing demand for energy savings. The new Iridium² HID optics are designed to deliver best-in-class lighting performance while offering tremendous flexibility in application. All these features, combined with Iridium²'s ease of installation and maintenance, ensure that customers enjoy low cost of ownership.

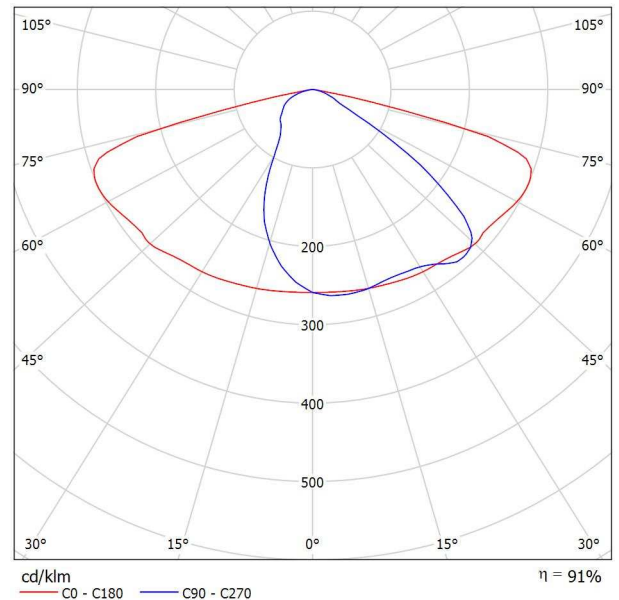

På grunn av manglende symmetriegenskaper kan det ikke vises noen UGR-tabell for denne lampen.



Prosjektutvikling Midt-Norge AS

Vestre Rosten 85
7075 TillerDesigner YR
Telefon
Faks
E-Post yngve@pumn.no

Utendørsriss / Armaturstykklister

2 Antall PHILIPS BGP352 T25 1xGRN49-3S/740 DW
 Artikkelnr.:
 Lysstrøm (Armatur): 4641 lm
 Lysstrøm (Lamper): 5100 lm
 Armatureffekt: 39.0 W
 Armaturklassifisering etter CIE: 100
 CIE Flux Code: 39 75 97 100 91
 Bestykning: 1 x GRN49-3S/740
 (Korreksjonsfaktor 1.000).

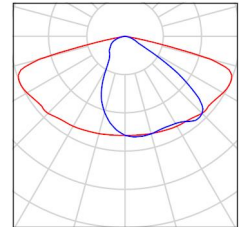

10 Antall PHILIPS BPP530 T25 1 xLED35/740 DW
 Artikkelnr.:
 Lysstrøm (Armatur): 3010 lm
 Lysstrøm (Lamper): 3500 lm
 Armatureffekt: 22.5 W
 Armaturklassifisering etter CIE: 100
 CIE Flux Code: 38 72 97 100 86
 Bestykning: 1 x LED35/740/- (Korreksjonsfaktor 1.000).

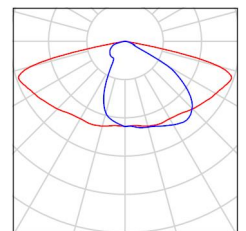

1 Antall PHILIPS BPP530 T25 1 xLED40/740 DK DF
 Artikkelnr.:
 Lysstrøm (Armatur): 2840 lm
 Lysstrøm (Lamper): 4000 lm
 Armatureffekt: 26.0 W
 Armaturklassifisering etter CIE: 100
 CIE Flux Code: 41 76 96 100 71
 Bestykning: 1 x LED40/740/- (Korreksjonsfaktor 1.000).

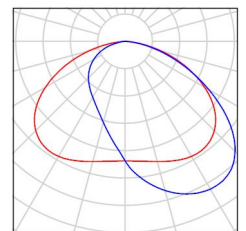



Prosjektutvikling Midt-Norge AS

Vestre Rosten 85
7075 TillerDesigner YR
Telefon
Faks
E-Post yngve@pumn.no

Utendørsriss / Gatevurderingsfelter (koordinatliste)

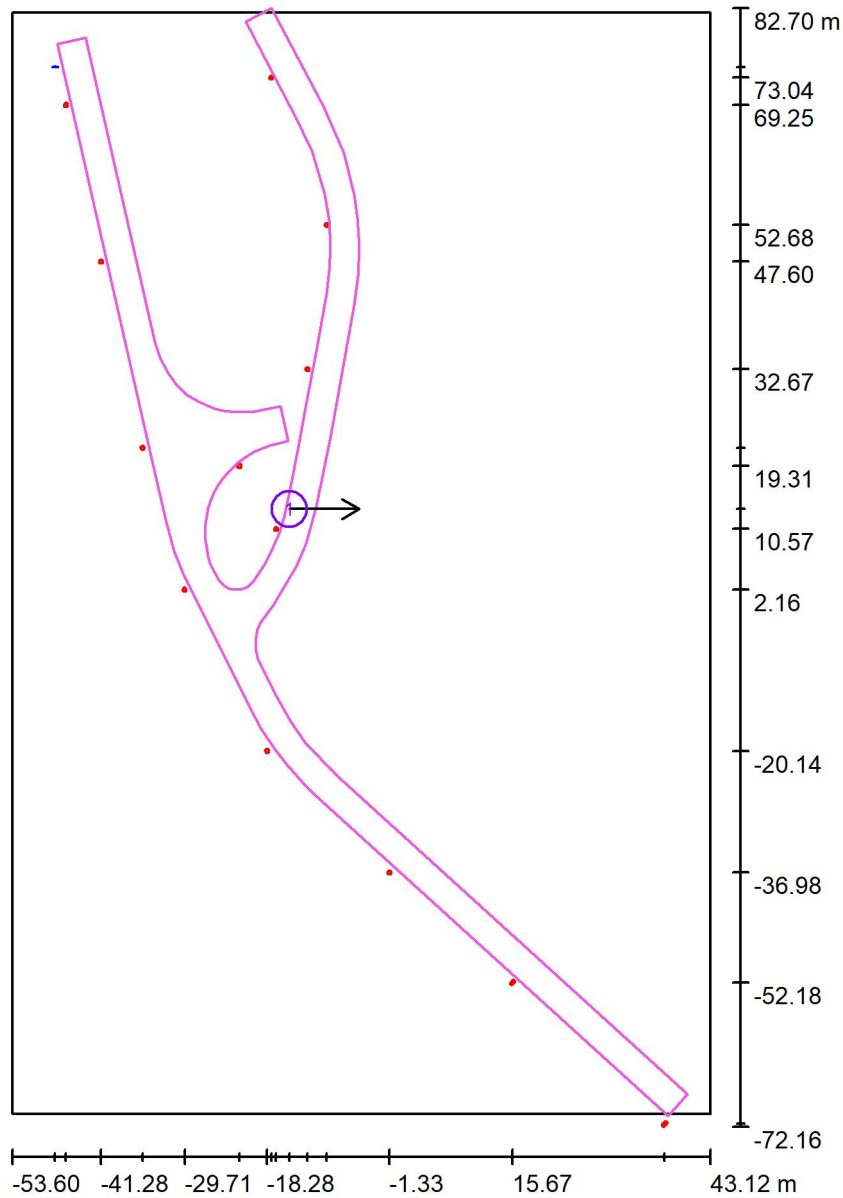

Målestokk 1 : 1048

Pseudo-vurderingsfeltliste

Nr.	Betegnelse	Posisjon [m]			Størrelse [m]		Synsretning [°]	Målepunkter
		X	Y	Z	L	B		
1	Gatevurderingsfelt 1	-15.214	13.345	0.000	87.267	153.336	0.0	75 x 75



Prosjektutvikling Midt-Norge AS

Vestre Rosten 85
7075 Tiller

Designer YR
Telefon
Faks
E-Post yngve@pumn.no

Utendørsriss / Rendering av falske farger

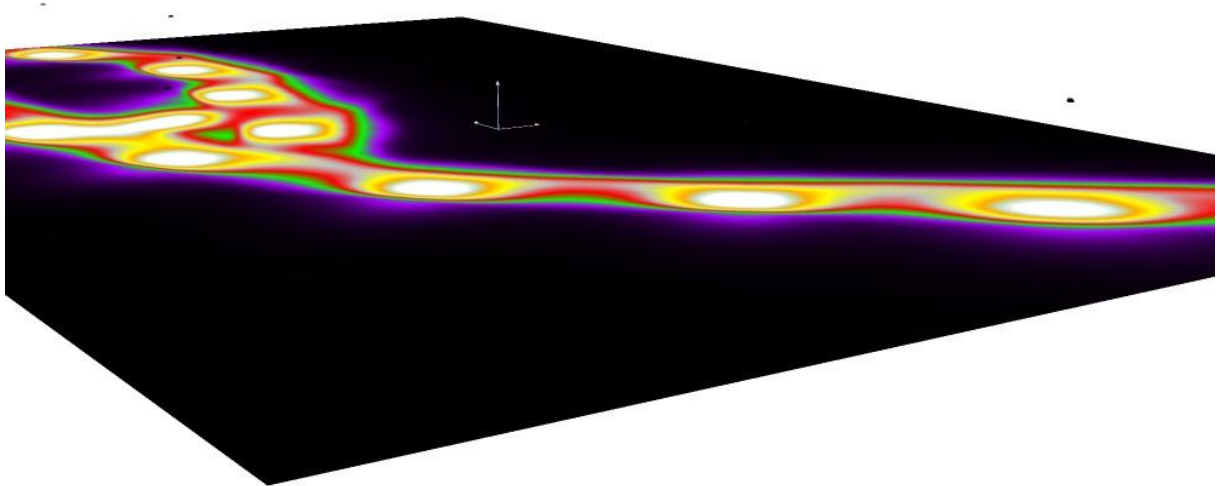

0 1.88 3.75 5.63 7.50 9.38 11.25 13.13 15

lx



Prosjektutvikling Midt-Norge AS

Vestre Rosten 85
7075 Tiller

Designer YR
Telefon
Faks
E-Post yngve@pumn.no

Utendørsriss / Gatevurderingsfelt 1 / Gråskala (E)

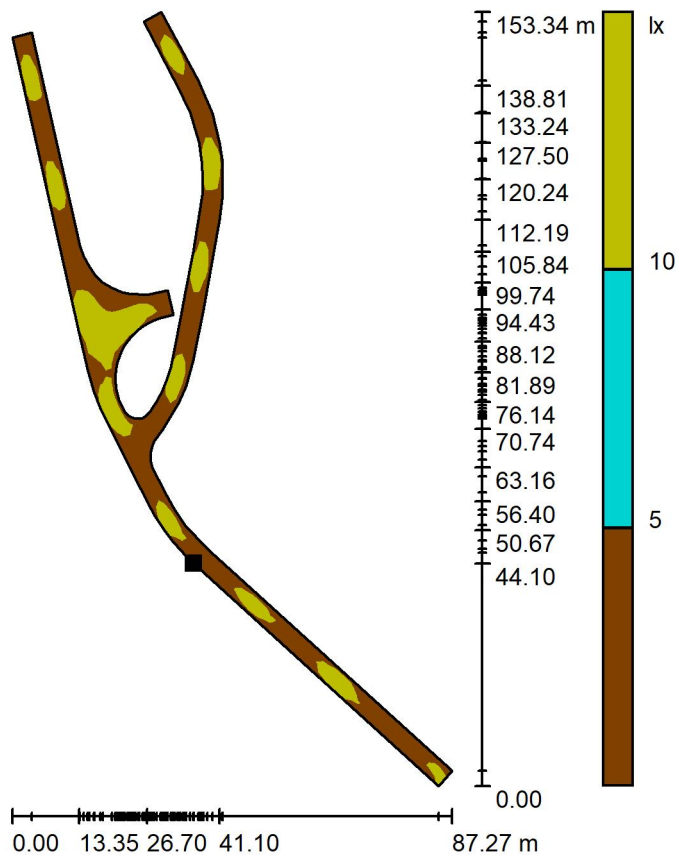

Målestokk 1 : 1500

Overflatens plassering i
utendørsrisset:
Markert punkt:
(-11.313 m, -26.536 m, 0.000 m)

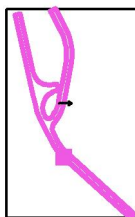

Målepunkter: 75 x 75 Punkter

E_m [lx]	E_{min} [lx]	E_{max} [lx]	E_{min} / E_m	E_{min} / E_{max}
10	4.10	19	0.407	0.211

Rotasjon: 0.0°

Prosjektutvikling Midt-Norge AS

Vestre Rosten 85
7075 TillerDesigner YR
Telefon
Faks
E-Post yngve@pumn.no**Boliggate / Planleggingsdata****Veiprofil**

Kjørebane 1 (Bredden: 4.000 m, Antall kjørefelt: 1, Belegg: R3, q0: 0.070)

Vedlikeholds faktor: 0.80

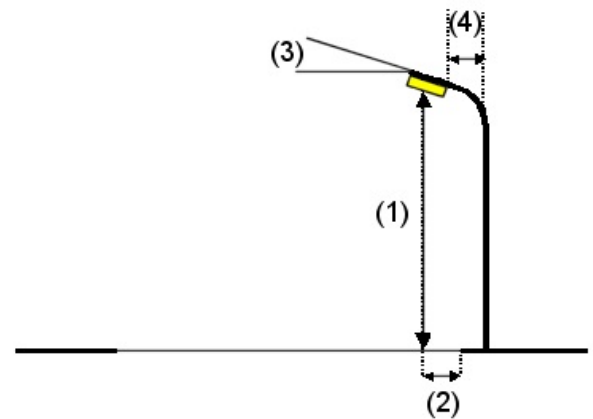
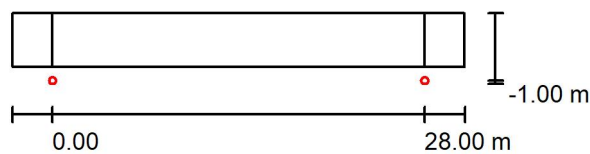
Armaturarrangementer

Armatur:	PHILIPS BGP530 T25 1 xLED35/740 DW	
Lysstrøm (Armatur):	3010 lm	Maksimalverdier for lysstyrke
Lysstrøm (Lamper):	3500 lm	ved 70°: 644 cd/klm
Armatureffekt:	22.5 W	ved 80°: 78 cd/klm
Arrangementet:	ensidig nede	ved 90°: 0.00 cd/klm
Stolpeavstand:	28.000 m	I alle retninger som danner den oppgitte vinkelen med den nedre vertikalen ved bruksklar installert lampe.
Montasjehøyde (1):	6.000 m	Ingen lysstyrke over 90°.
Lyspunkthøyde:	5.900 m	Arrangementet oppfyller lysstyrkeklassen G3.
Overheng (2):	-1.000 m	Arrangementet oppfyller blendindexklassen D.6.
Utliggervinkel (3):	0.0 °	
Utliggerlengde (4):	0.000 m	

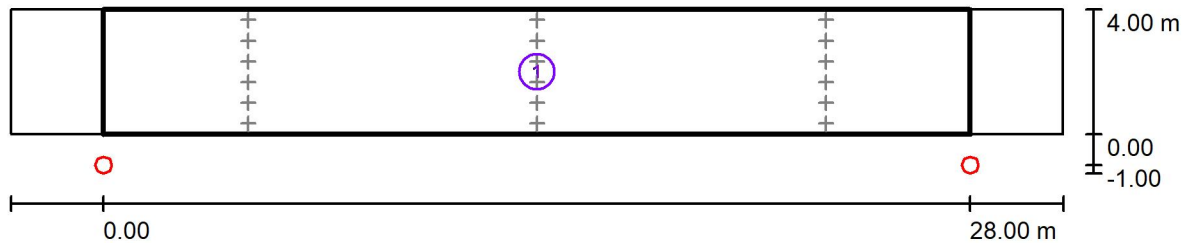

Prosjektutvikling Midt-Norge AS

Vestre Rosten 85
7075 TillerDesigner YR
Telefon
Faks
E-Post yngve@pumn.no**Boliggate / Lystekniske resultater**

Vedlikeholdsfaktor: 0.80

Målestokk 1:244

Vurderingsfeltliste

- Vurderingsfelt Kjørebane 1
Lengde: 28.000 m, Bredde: 4.000 m
Målepunkter: 3 x 6 Punkter
Tilhørende veielement: Kjørebane 1.
Valgt lysklasse: CE5

(Alle fotometriske krav er oppfylte.)

Faktisk-verdier i samsvar med beregning:
Nominelle verdier i samsvar med klasse:
Oppfylt/ikkje oppfylt:

E_m [lx]	U0
7.63	0.44
≥ 7.50	≥ 0.40
✓	✓

Prosjektutvikling Midt-Norge AS

Vestre Rosten 85
7075 TillerDesigner YR
Telefon
Faks
E-Post yngve@pumn.no**Adkomstvei / Planleggingsdata****Veiprofil**

Kjørebane 1 (Bredden: 4.000 m, Antall kjørefelt: 1, Belegg: R3, q0: 0.070)

Vedlikeholds faktor: 0.80

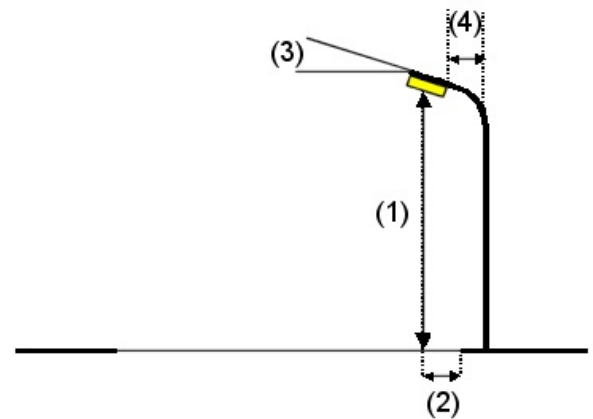
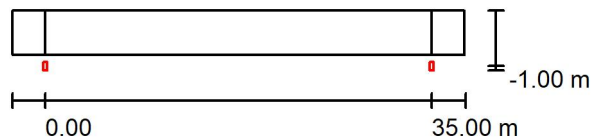
Armaturarrangementer

Armatur:	PHILIPS BGP352 T25 1xGRN49-3S/740 DW	
Lysstrøm (Armatur):	4641 lm	Maksimalverdier for lysstyrke
Lysstrøm (Lamper):	5100 lm	ved 70°: 635 cd/klm
Armatureffekt:	39.0 W	ved 80°: 36 cd/klm
Arrangementet:	ensidig nede	ved 90°: 0.00 cd/klm
Stolpeavstand:	35.000 m	
Montasjehøyde (1):	8.000 m	
Lyspunkthøyde:	7.817 m	
Overheng (2):	-1.000 m	
Utliggervinkel (3):	0.0 °	
Utliggerlengde (4):	0.000 m	

I alle retninger som danner den oppgitte vinkelen med den nedre vertikalen ved bruksklar installert lampe.

Ingen lysstyrke over 90°.

Arrangementet oppfyller lysstyrkeklassen G3.

Arrangementet oppfyller blendindexklassen D.6.



Prosjektutvikling Midt-Norge AS

Vestre Rosten 85
7075 Tiller

Designer YR
Telefon
Faks
E-Post yngve@pumn.no

Adkomstvei / Armaturstykkliste

PHILIPS BGP352 T25 1xGRN49-3S/740 DW
Artikkelnr.:
Lysstrøm (Armatur): 4641 lm
Lysstrøm (Lamper): 5100 lm
Armatureffekt: 39.0 W
Armaturklassifisering etter CIE: 100
CIE Flux Code: 39 75 97 100 91
Bestykning: 1 x GRN49-3S/740
(Korreksjonsfaktor 1.000).

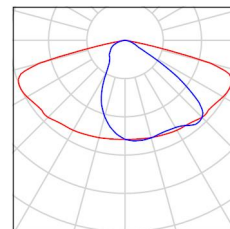

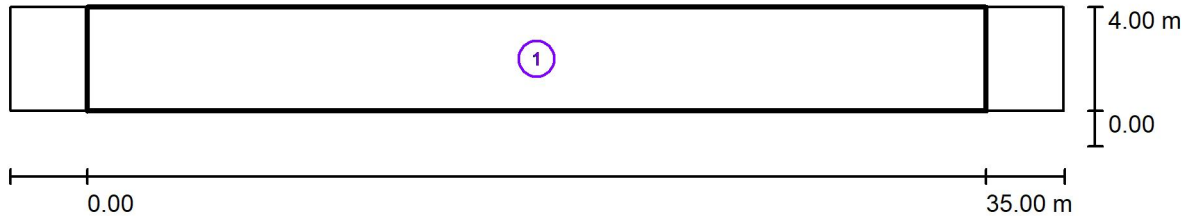

Prosjektutvikling Midt-Norge AS

Vestre Rosten 85
7075 TillerDesigner YR
Telefon
Faks
E-Post yngve@pumn.no**Adkomstvei / Lystekniske resultater**

Vedlikeholdsfaktor: 0.80

Målestokk 1:294

Vurderingsfeltliste

- 1 Vurderingsfelt Kjørebane 1
Lengde: 35.000 m, Bredde: 4.000 m
Målepunkter: 10 x 6 Punkter
Tilhørende veielement: Kjørebane 1.
Valgt lysklasse: CE5 (Alle fotometriske krav er oppfylte.)

Faktisk-verdier i samsvar med beregning:
Nominelle verdier i samsvar med klasse:
Oppfylt/Ikkje oppfylt:

E_m [lx]	U0
7.60	0.44
≥ 7.50	≥ 0.40
✓	✓