

EURO 9011-9016

Sida

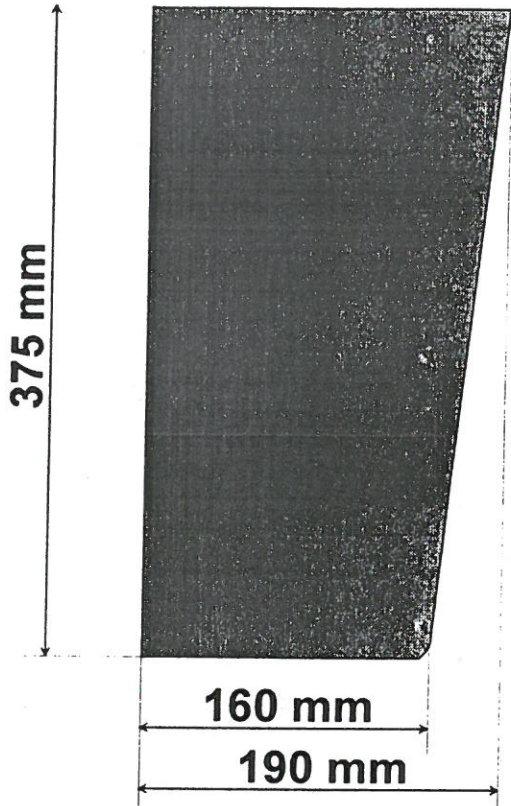

Front

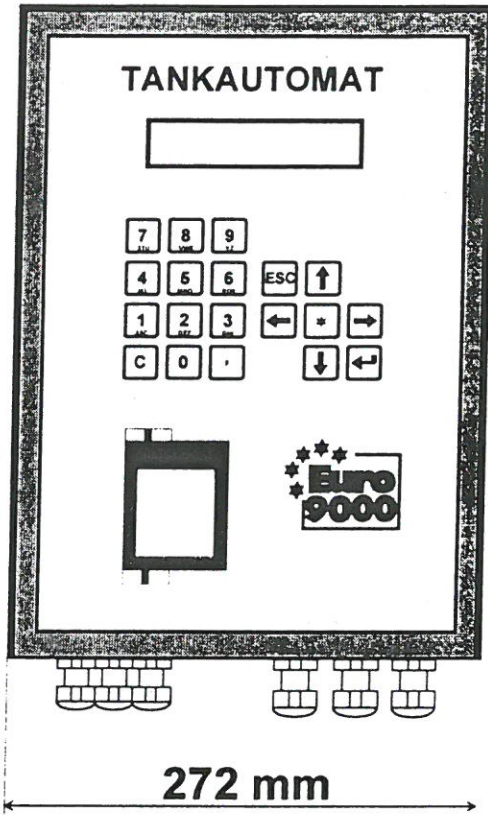

Undersida

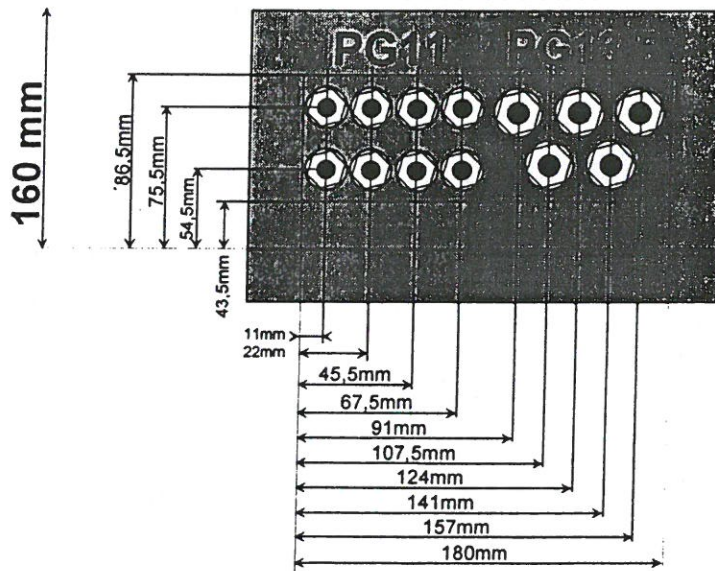

Konstr.	Datum	Name	Dohmann GmbH EURO 9011-9016	EURO 9011-9016 Terminalmätt
Gez.	02.10.1996	Salzwedel		
Gepr.				
Rev.				
Rev.				

Ritnings Nr.: 9406021

Protokollskrivare
(även för montering i terminalen)

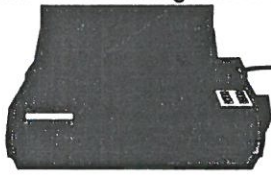

Kvittoskrivare
(även för montering i terminalen)

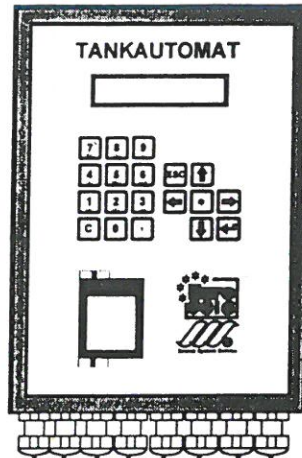
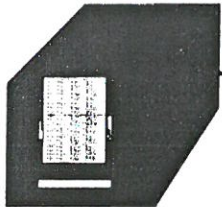

EURO
9011-9016

EPSI-Bus

Nästa Terminal

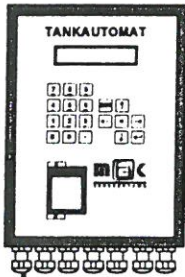

Max. 32 Terminaler

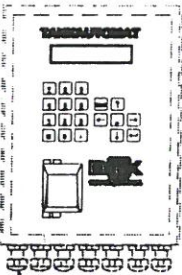

Snittställe till Elektronikpumpar

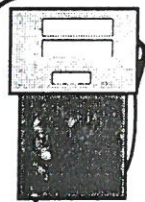

Max. 28 Tappställen

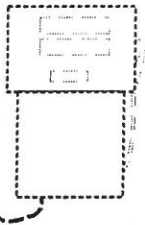

Modem Snittställe

Modem



Pulsgivare 1

Pulsgivare 2...6

Pump 1

Pump 2...6

Pistolbrytare 1

Pistolbrytare 2...6

Konstr.	Datum	Name		
Gez.	22.08.1996	Salzwedel	Dohmann GmbH	EURO Blockritning
Gepr.			EURO	
Rev.			9011-9016	
Rev.				
				Ritning nr.: 9346022