

LEGEND

RELEASED

All measurements have to be revised carefully by the contractor/executor and compared with on-site situations. Differences concerning measurements or planning / stock have to be conveyed immediately to the designer. Details and drawings are only valid with annotation of approval by the designer.

MODIFICATION NOTE

Ind. date	sign changes / comments
d	
c	
b	
a	

PLANNERS / EXPERTS

planner exhibition scenography **ATELIER BRÜCKNER GMBH**
Krefelder Strasse 32
70376 Stuttgart | Germany
T. +49 711 5000 77 116
F. +49 711 5000 77 22
ngm@atelier-brueckner.com

light planner **Belzner Holmes LDE**
Friedrichstrasse 236
10969 Berlin
T. +49 (0)30 / 863 207 722
F. +49 (0)30 / 863 207 729
s.schuster@bh.lde-net.com

media planner **Medienprojekt P2 GmbH**
Lindenspürstrasse 20
70174 Stuttgart | Germany
T. +49 711 601 87 46 0
F. +49 (0)711 601 87 46 50
a.mueller@medienprojekt2.de

graphic + software planner **ATELIER BRÜCKNER GMBH**
Krefelder Strasse 32
70376 Stuttgart | Germany
T. +49 711 5000 77 116
F. +49 711 5000 77 22
ngm@atelier-brueckner.com



NORWEGIAN PRINTING MUSEUM
STAVANGER

KEY PLAN

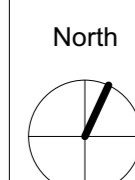
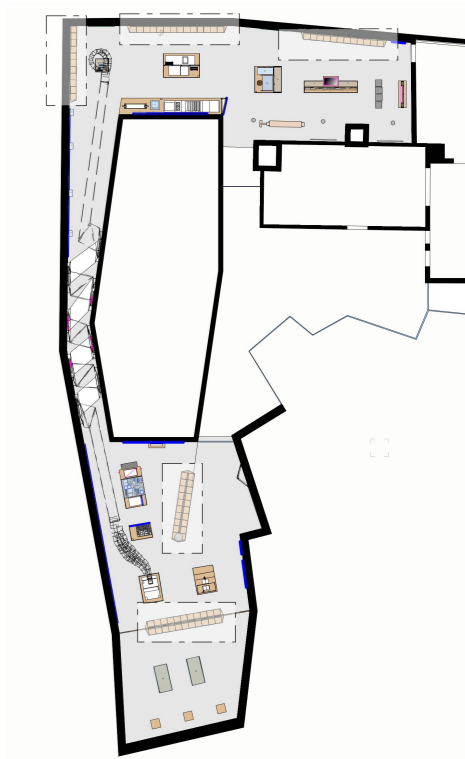

NORWEGIAN PRINTING MUSEUM
Lettercase Shelf - General Detail

client **Museum Stavanger**
Øvre Strandgate 88
4005 Stavanger | Norwegian
T. +47 40 60 17 01
www.museumstavanger.no
bitten.bakke@museumstavanger.no

planner exhibition scenography **ATELIER BRÜCKNER GMBH**
Krefelder Strasse 32
70376 Stuttgart | Germany
T. +49 711 5000 77 116
F. +49 711 5000 77 22
ngm@atelier-brueckner.com

papersize scale unit sign
DIN A1 **1:20/10** **mm** **sm**

filename
NGM-ATB_F_1.0.1.0_02

date code planningphase
13.09.2019 **NGM-ATB** **LPH 4 - DD**

type hierarchy no. index
F **1.0.1.0** **02** **00**

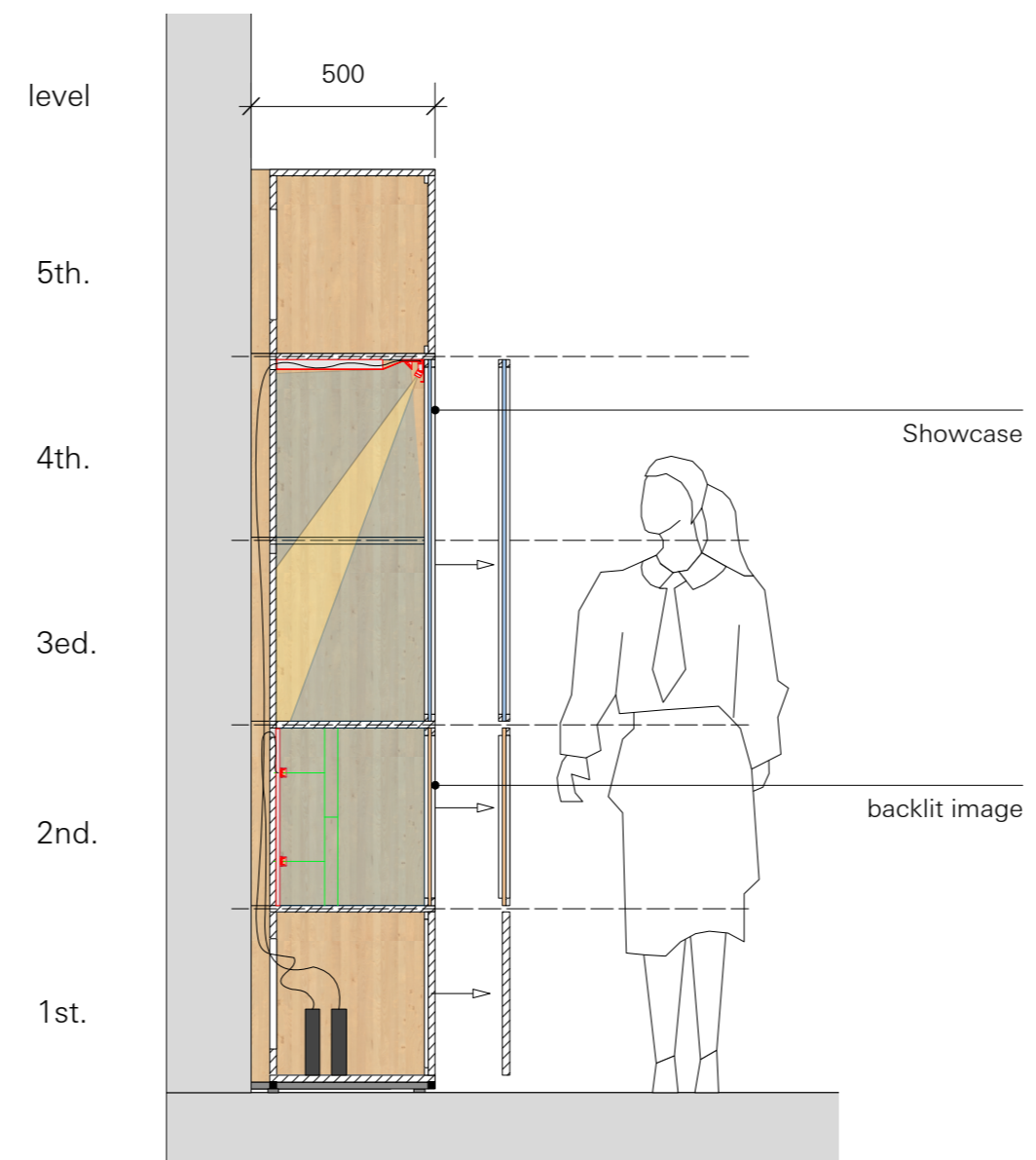
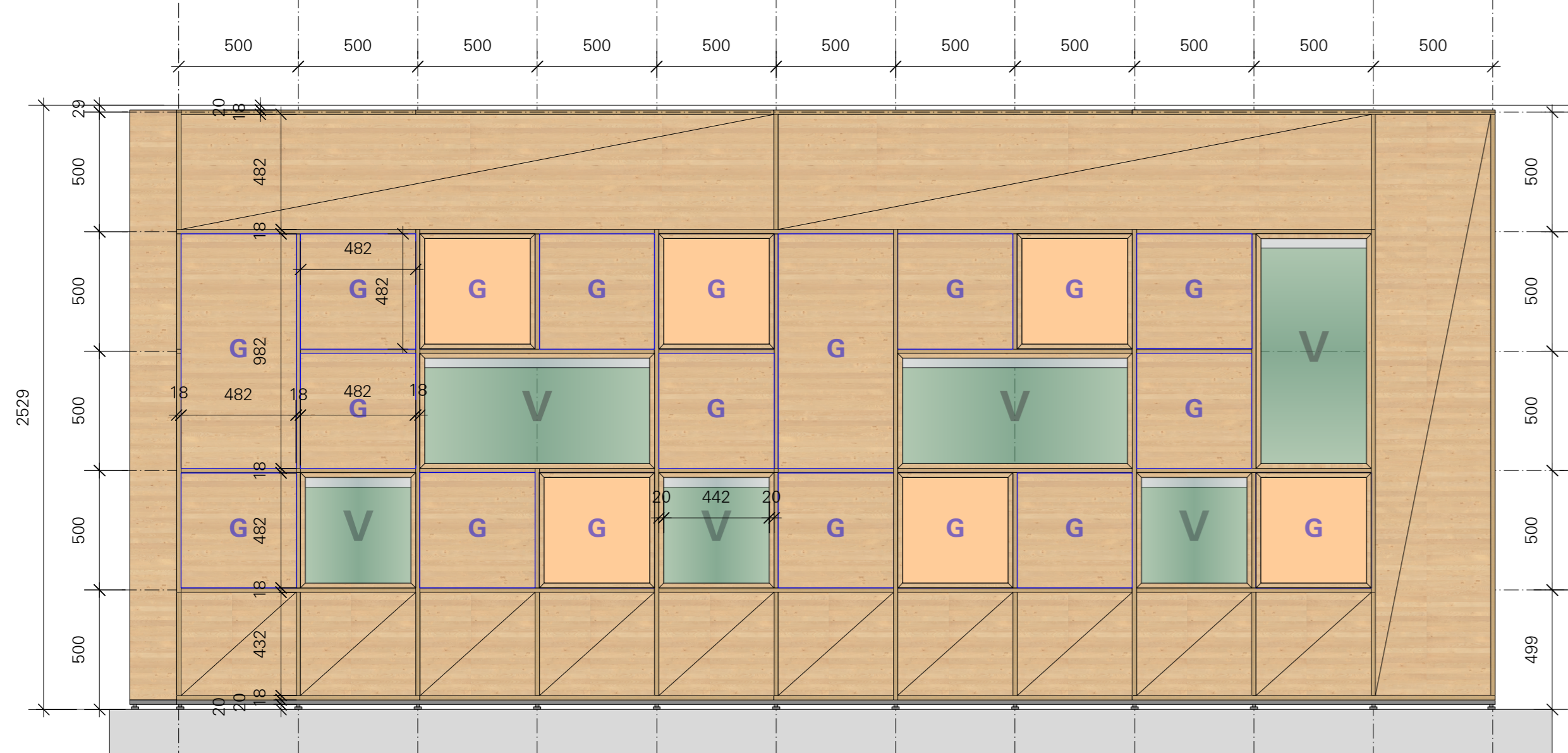

Modular Lettercase Shelf System:

The Lettercase shelf is a system furniture providing flexible space for exhibits and graphics. The inside of the shelf can be adapted with different shelf components and enlarged when needed according to the grid.

Components for shelf
Scale 1:20

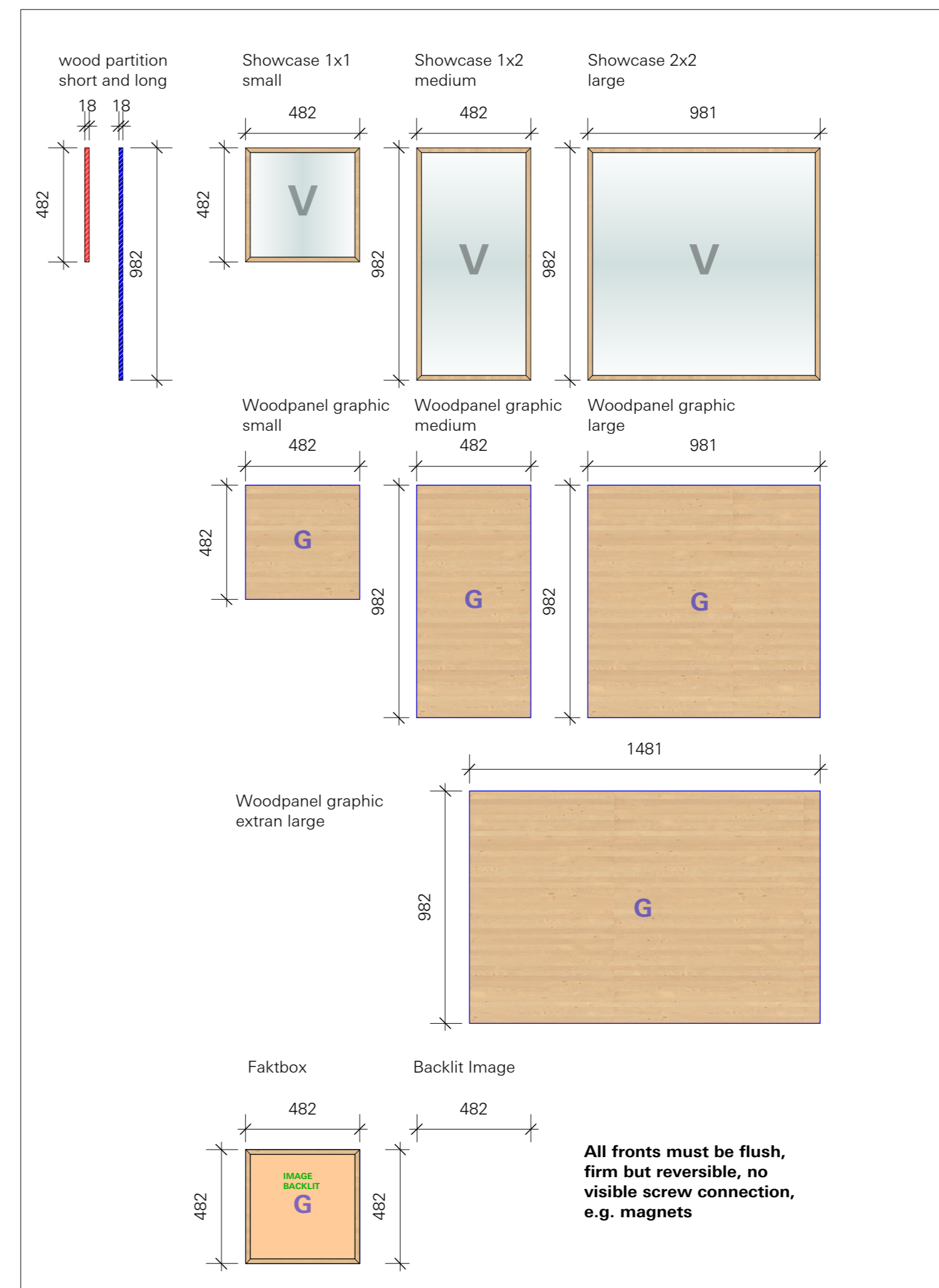

ELEVATION
Lettercase Shelf full equipped with shelf components
M 1:20

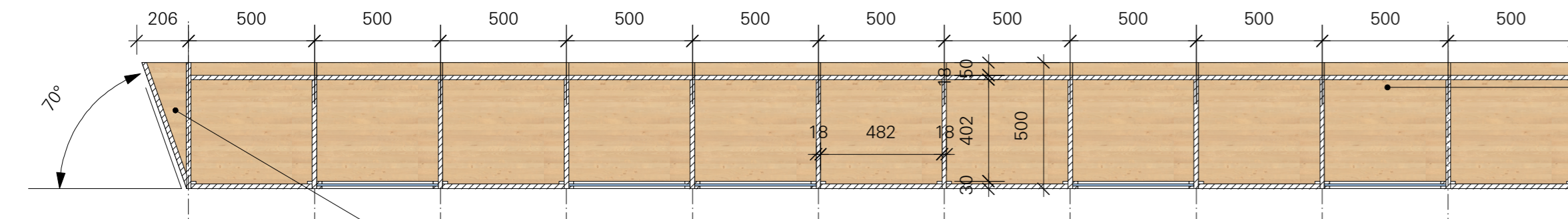

HORIZONTAL SECTION
Lettercase Shelf full equipped with shelf components
M 1:20

modular shelf system, wood, acc. to material list and conservatory requirements see plan: NGM-ATB_D_1.0.1.0_01

Side triangle, wood, acc. to material list, attached to all shelf sides

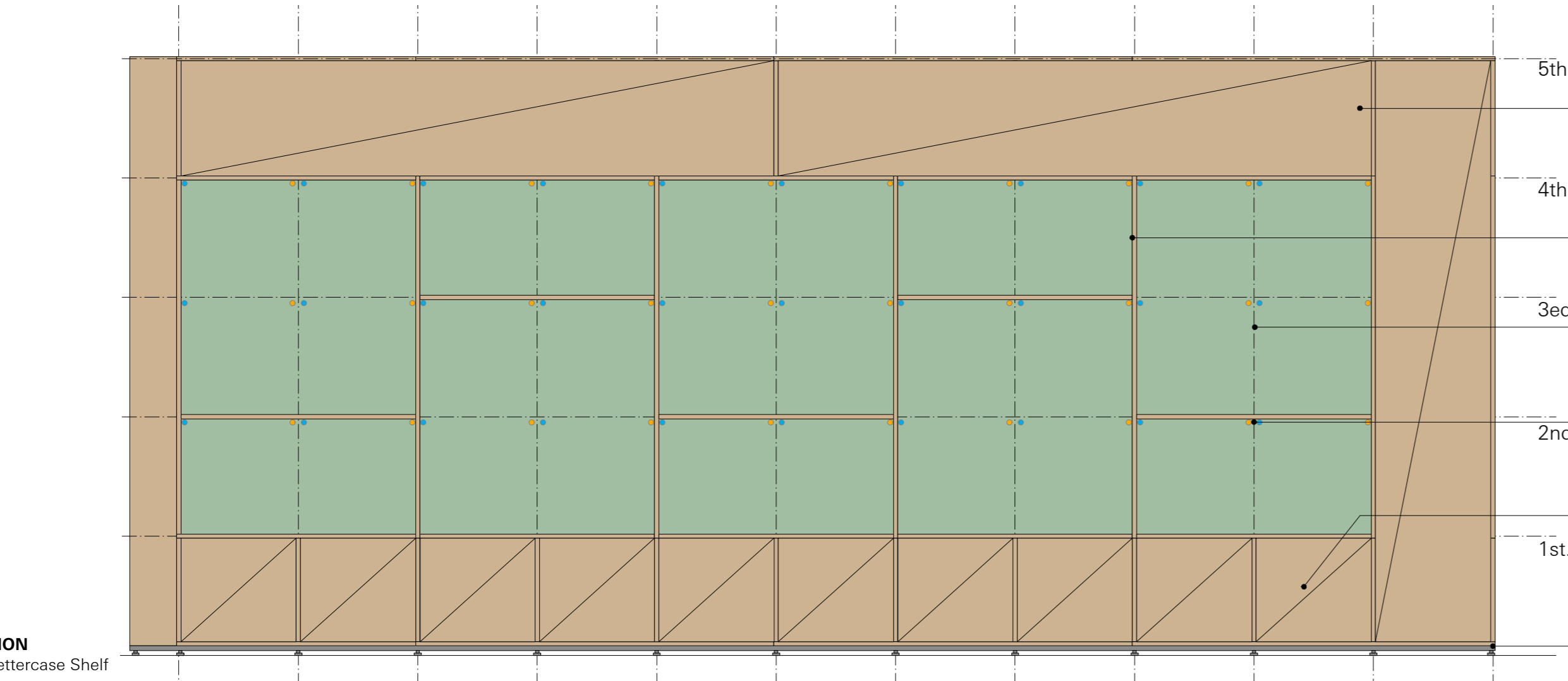

ELEVATION
Empty Lettercase Shelf
1:20

empty shelf, shows the condition of the shelf without flexible shelf components. all dividers shown here are permanently fixed and serve as static/substructure for the shelf, components and exhibits.

wood panels, max 2.5m length, detachable for revision, invisible fixation eg. Keku profile, Module Title, direct print on wood (trade: graphic)

solid shelf structure, permanent fixed, acc. to static requirements

flexible compartment floor can be inserted here, acc. to static requirements

two holes in backwall per square for cabling of light lightmodule, d= acc. to lightplanner

wood panels, detachable for revision of light trafo, invisible fixation eg. Keku profile, back open for cabling

steel frame basis ca. 18mm, acc. to static req. with height adjustable feed, as many as needed to level shelf and allow stable stand

shelf compartment floor, can be inserted horizontal and vertical along grid line, multiplex birch, ca. 18mm, with groove, can be removed to the front, secured with grub screw from bottom

Light cassette mounting, L-shaped metal suspension on which cassette is pushed on to.

Light cassette, acc. to light planners. see plan: NGM-ATB/BH_D_1.0.0_01 and following

Mounting for all components, flush to shelf front, reversible, eg. magnet (Häfele)

showcase component, glass, laminated safety glass or cast acrylic glass, mounted into ca. 20mm multiplex birch frame.

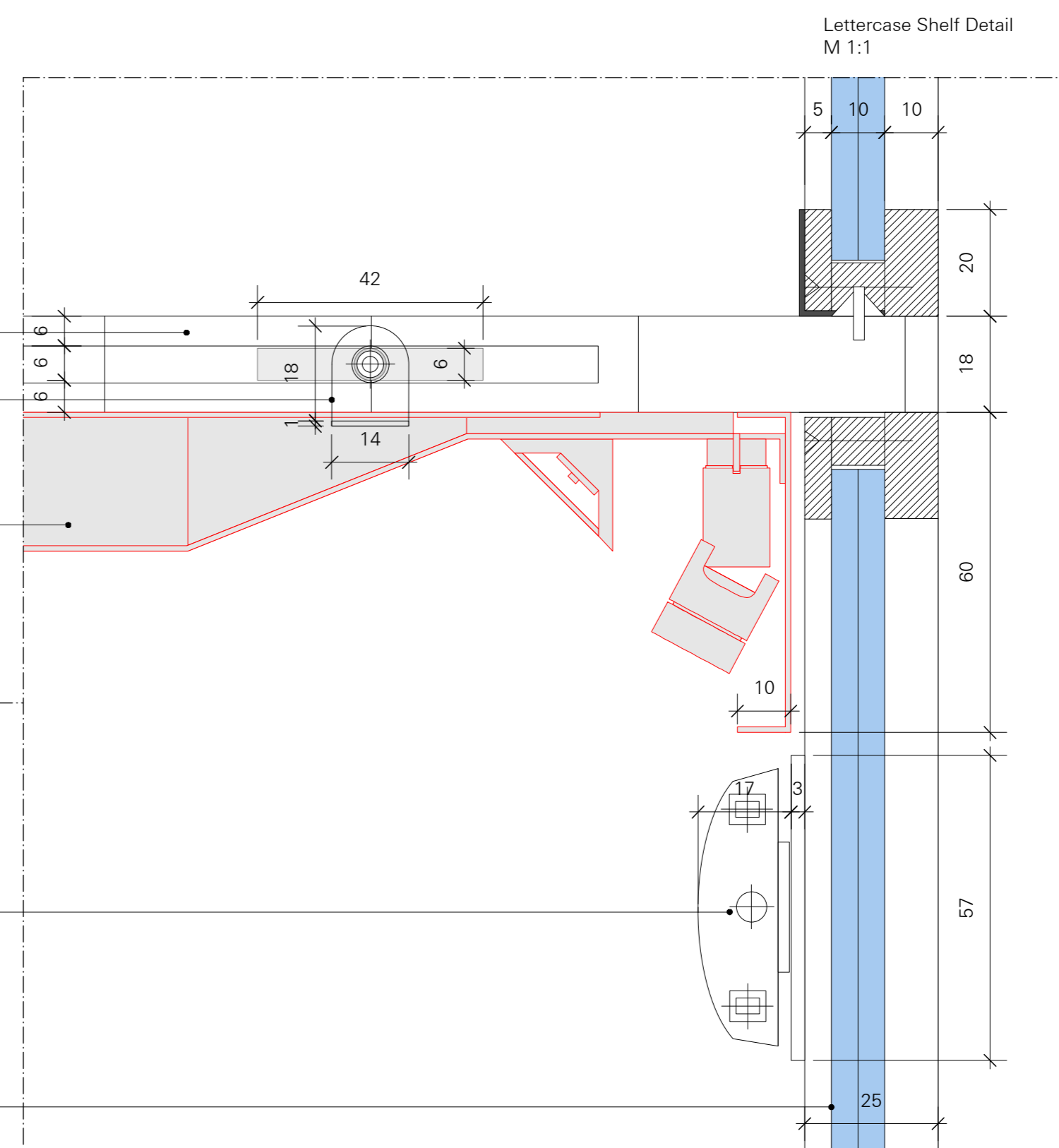

Empty Lettercase Shelf
M 1:20

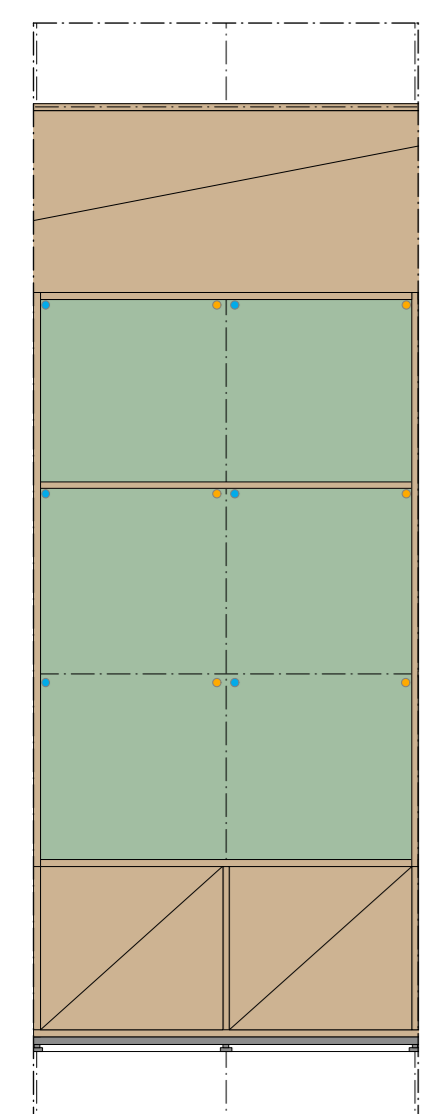

Lettercase Shelf with compartment floors equipped
M 1:20

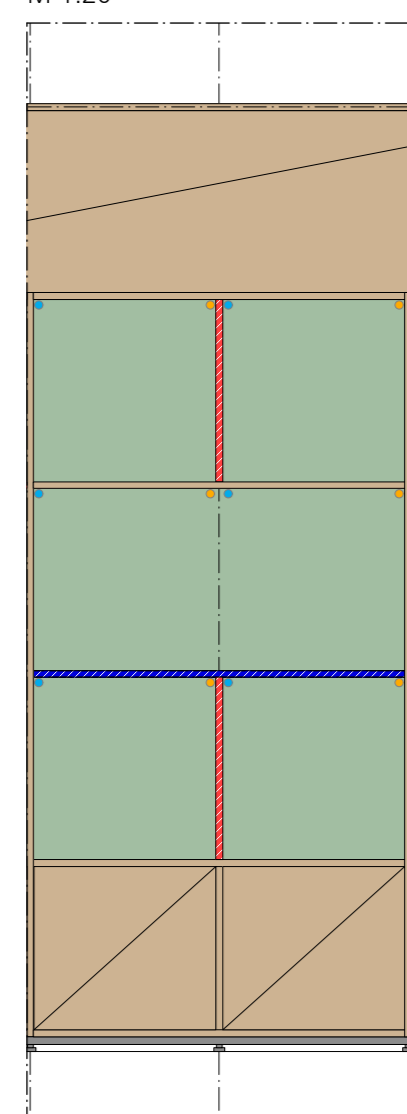

Lettercase Shelf equipped with shelf components
M 1:20

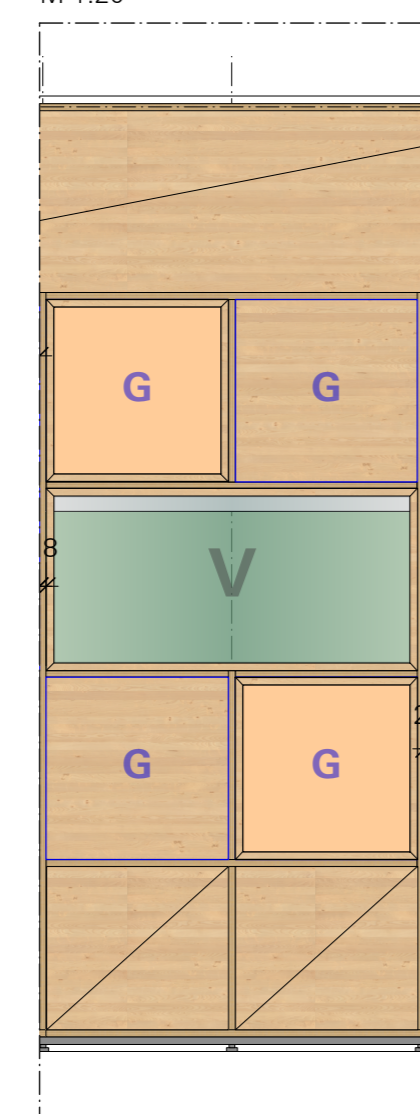

Lettercase Shelf section
M 1:20

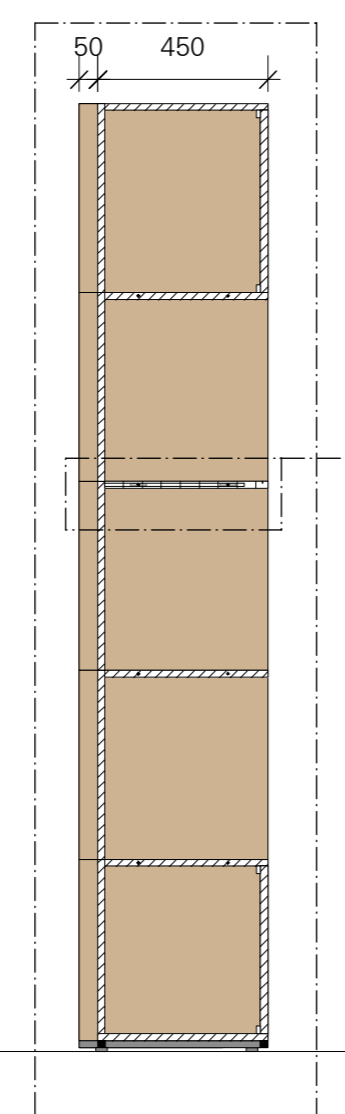

Lettercase Shelf Detail
M 1:5

